

SECONDARY OPERATION FOR SENSOR COILS
GOING INTO COMPARITORS USING P/N 04050028

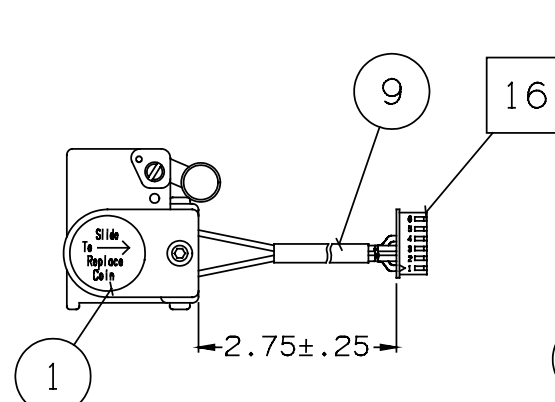

FINAL ASSEMBLY FOR 3" COILS

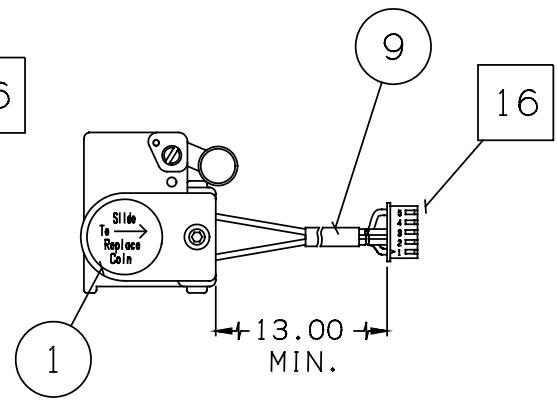

FINAL ASSEMBLY FOR 13" COILS

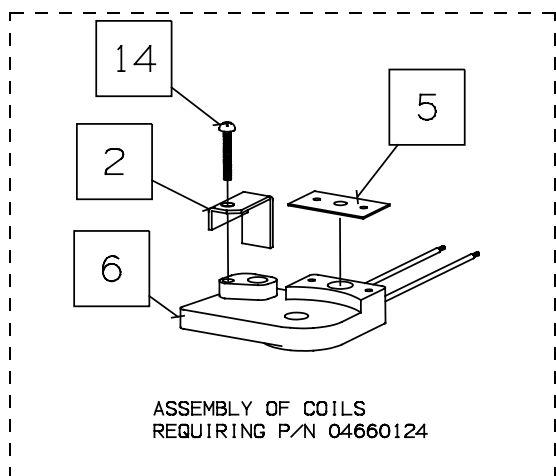
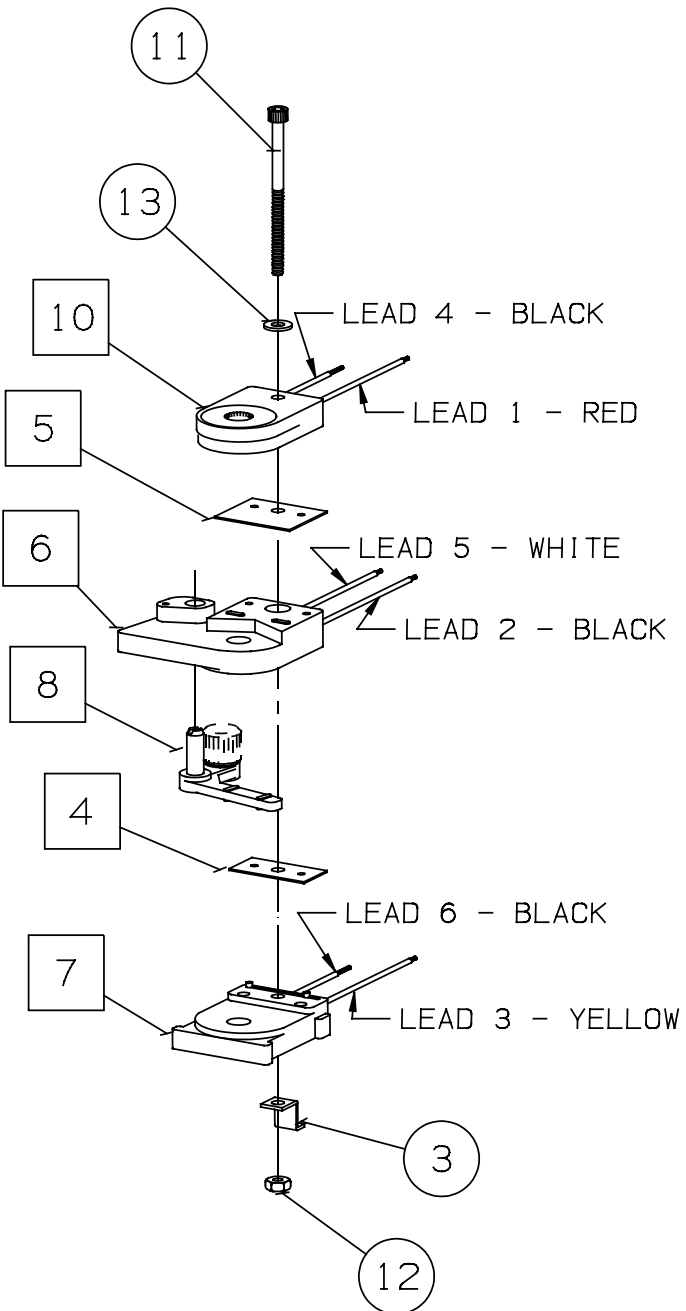

ASSEMBLY OF COILS
REQUIRING P/N 04660124

- NOTES:
 1. SEE INDIVIDUAL BILLS OF MATERIALS FOR VARIABLE SINGLE COMPONENTS INDIVIDUAL COMPONENTS INDICATED BY SQUARE BALLOONS.
 2. SEE DWG ENG00098 FOR WIRING SEQUENCES.
 3. FOR COIL ASSY'S CONTAINING P/N 05250032 (BI-METAL COIL), WHEN ONE SPACER (P/N 04660193) IS CALLED OUT, PLACE IT BETWEEN THE #2 AND #3 COIL.

MATERIAL COLUMN			
ITEM	P/N	QTY	MATL' DESCRIPTION
1	04090301	1	LABEL, SLIDE TO REPLACE
2	04660124	1	BRKT, COIN GUIDE, DEEP SEAT
3	04660070-01	1	BRKT, SPRING RETURN
4	04660180	1	SHIM, #1, SENSOR, .025
5	0466XXXX	1	SHIM, #3, SENSOR,
6	0525XXXX	1	COIL, ASSY, SENSOR, #2,
7	0625XXXX	1	COIL, ASSY, SENSOR, #1,
8	0666XXXX	1	DAMPNER & WEIGHT, ASSY,
9	08290084	.006	HEAT SHRINK, 3/16" BLK, UL/CSA, 3/4" LG
10	0925XXXX	1	COIL, ASSY, SENSOR, #3,
11	118S4-24	1	SCREW, 4-40 X 1-1/2, SOCKET HEAD CAP SCREW
12	406-4	1	NUT, 4-40, 3/32 X 1/4, HEX STEEL
13	600-4	1	WASHER, FLAT,
14	P-217-2-5	1	SCREW, 2-1/4, PHIL, PH, HI-LO
15	0826-003072	A/R*	CONTACT, SPH
16	XXXXXXXX	A/R*	HSG, SPH

* AS REQUIRED

		CORRECTED CALL-OUT; PUT P/N IN ITEM 15	7/10/03 DF
		2.75±.25 WIRE LENGTH WAS 3.00 MIN ON FINAL ASSEMBLY DETAIL	4/2/03 DF
	6606	ADDED NOTE 3 DESCRIBING SINGLE SPACER PLACEMENT IN BM COILS	11/7/01 DW
	6085	P/N 04660180 WAS P/N 04660037; P/N 04660181 WAS P/N 04660180 REMOVED P/N 06660029 AND SINGLE COMPONENTS PICTORIALS	4/20/00 DW
		REMOVED VIEWS FOR CC-32, CC-36, AND CC-46	1-23-97 DW
		DWG WAS P/N SPECIFIC, NOW IS FOR GENERAL ASSEMBLY ADD NOTE 1	1-3-96 DW

NO.	ECO NO.	REVISIONS	DATE/BY
-----	---------	-----------	---------

<p>COIN MECHANISMS INC. 400 REGENCY DR. GLENDALE HEIGHTS, IL 60139</p>	<p>TOLERANCES NOT SPECIFIED FRACTIONS= ± 1/64 ANGLES= ± 1° .XX= ± .010 .XXX= ± .005 HOLE DIA.= ± .002</p>	<p>TITLE COIL, ASSY, SENSOR, SOCKET HEAD CAP SCREW</p>	
		<p>CHKD</p>	<p>DATE</p>
<p>This drawing is the property of and contains proprietary information of Coin Mechanisms Inc. The drawing shall be returned upon request and is not to be copied or disclosed without written authorization and will not be used in any way detrimental to the interest of Coin Mechanisms.</p>	<p>CRITICAL SYMBOLS ▼ = CUSTOMER ▼ = PROCESS ▼ = BOTH</p>	<p>APP</p>	<p>DATE</p>
		<p>DWG NO. D0625002</p>	