

## SECTION 7 - PARTS CATALOG

INTRODUCTION	7-3
DESCRIPTION	7-3
ORDERING REPLACEMENT PARTS	7-3
PARTS BREAKDOWN	7-3

FIGURE	TITLE	PAGE
1	R-90 Phonograph Assembly	7-4
2	Front Door Assembly	7-16
3	Top Door Assembly	7-18
4	OEM Bill Acceptor	7-24
5	Light Display Control	7-26
6	Stereo Amplifier System Ass'y	7-28
7	Heat Sink Assembly	7-30
8	Output Transformer Ass'y	7-32
9	Central Control Computer	7-34
10	Main Power Supply	7-36
11	Mechanism Assembly	7-38
12	Tone Arm & Pivot Ass'y	7-46
13	Sprag Assembly	7-47
14	Cam Switch & Motor Ass'y	7-48
15	OBA-2 Kit R-90	7-49
16	Transport Assembly OBA	7-50
17	Stacker Assembly OBA	7-51

COUNTRY 1st & 2nd DIGIT	PACK 3rd DIGIT	R-90 SUB-ASSEMBLY 4th & 5th DIGIT	AMPLIFIER 6th DIGIT	BILL ACCEPTOR 7th DIGIT	COIN ACCEPTOR 8th DIGIT
01 = US	1 = Unpack	81 = Blue (60HZ) 6-09900-01	0 = None	0 = None	0 = None
02 = Arg	2 = DonPack	82 = Brown (60HZ) 6-09900-02	1 =	1 =	1 = 3 Coin Acceptor = 4-06961-01
03 = Australia	3 = ExPack	83 = Blue Static - Video Mono (60HZ) 6-09900-03	2 =	2 =	2 = 4 Coin Acceptor = 4-07156-01
04 = Aus	4 = Sp'1 Pack = ?	84 = Blue (50HZ) 6-09900-04	3 =	3 =	3 = Export Reflector (Special) 7-09519-XX
05 = Bah		85 = Brown (50HZ) 6-09900-05	4 =	4 =	4 = 3 Coin Canadian Border = 4-06962-01
06 = Bel'g		86 = Blue Static - Video Mono (50HZ) 6-09900-06	5 = 50W	5 =	5 = 4 Coin Canadian Border = 4-07159-01
07 = Canada		87 = Blue Static - Video Mono (60HZ) with (2-18826-01) Monitor Kit 6-09900-08	6 = 125W = 6-09941-01 (incl Canada)	6 =	6 = Kit - Mars Slug Reflector = 2-18851-03
08 = Chile		88 = Blue Static (60HZ) 6-09900-08		7 =	7 = 4 Coin 5 Acceptor = 4-07156-02
09 = Col		89 = Brown Static (60HZ) 6-09900-09		8 =	8 = 2 Coin Acceptor = 4-07156-03 (25.5)
10 = Costa R		90 = Blue Static (50HZ) 6-09900-10		9 =	9 = Canadian Border \$ = 4-07159-02 (5.10,25.5)
11 = Neutral Stock		91 = Brown Static (50HZ) 6-09900-11			
12 = Denmark					
13 = Ecuador					
14 = El Sal'v					
15 = England					
16 = Finland					
17 = France					
18 = Germany					
19 =					
20 = Guat					
21 = Holland					
22 = Hon					
23 = Italy					
24 = Belize					
25 = Japan					
26 =					
27 = Nic					
28 = Norway					
29 = Aruba					
30 = Panama					
31 = Curaco					
32 =					
33 = Sweden					
34 = Swiss Fr					
35 = Swiss Ge					
36 = Swiss It					
37 = Trinidad					
38 =					
39 = Venez					
40 = Zambia					
41 = Puerto R					
42 = Guyana					
43 = Brazil					
44 = Barbados					
45 = Surinam					
46 = Yugo					
47 = S. Africa					

4th & 5th DIGIT	4th & 5th DIGIT	4th & 5th DIGIT
01-04	05-06 R-88 Audio	07-10 R-89
11-20	11-20 R-88 Video	
21-24	25-30 R-86	
31-34 R1-2	35-40 R1-4 & 5	
41-50 R1-3		41-50 R-89
51-54 C11-15	55-60 R-87	
61-70		
71-72 C11-2	73-80 C11-3	81-99 R-90

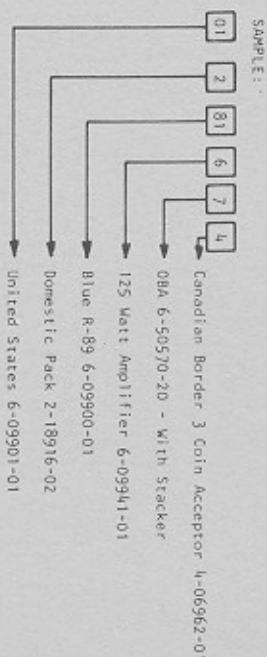

R-90 Code  
Rev. F

## INTRODUCTION

This parts catalog lists procurable replacement parts for the R-90 Phonograph. The purpose of this parts catalog is to locate and identify replaceable components and supply information on how to order them.

### Catalog Description

This catalog is divided into major sections labeled figures, which correspond to the illustrations used. Some assemblies require more than one illustration to identify the parts. Each page has a sheet number to identify the sheet as part of that assembly's parts list.

Since replacing parts that are welded or riveted onto an assembly is normally impractical, replacement parts are not listed for these items. The assembly that contains the welded part should be replaced.

### Parts List Description

The parts list contains four columns:

- Figure, Sheet, and Index Number - The first entry in this column is the figure number of the corresponding illustration. An index number, when listed, corresponds to the index number appearing on the illustration. Index numbers are not used when:
  - Items are listed for reference purposes only.
  - The item listed is an alternate part.
- Rowe Part Number - This column lists the part number to use when ordering replacement parts or making inquiries.
- Description - This column gives a word description of each part or assembly. Each item is indented to show its relationship to the next higher assembly.

- Qty. Per Ass'y. - This column contains the part quantity used in the assembly. When a figure describes more than one model of an assembly, the "Qty. Per Ass'y." column is divided to show each model.

## ORDERING REPLACEMENT PARTS

All replacement parts must be ordered directly from an authorized Rowe Distributor.

Once the replacement item has been determined, complete a Standard Parts Order Form (available from your Rowe Distributor at no charge). Very often parts orders are delayed because of inadequate or incompletely filled out parts order forms. To enable prompt delivery, always specify the following information:

- Part Number and Description (State color, if applicable.).
- Quantity required
- Machine Model and Serial Number
- Complete shipping address, including the ZIP code.
- Shipping Instructions must be supplied. If the shipping method is Parcel Post, Air Parcel Post, United Parcel Service, or Air UPS, and the packages may exceed the size and weight limits of these services, indicate an alternate shipping method.

If the shipment must be delivered as fast as possible, specify "Fastest Way". Rowe will select the carrier for orders that justify shipment by truck.

FIGURE  
1

# R-90 PHONOGRAPH ASSEMBLY SHEET 1

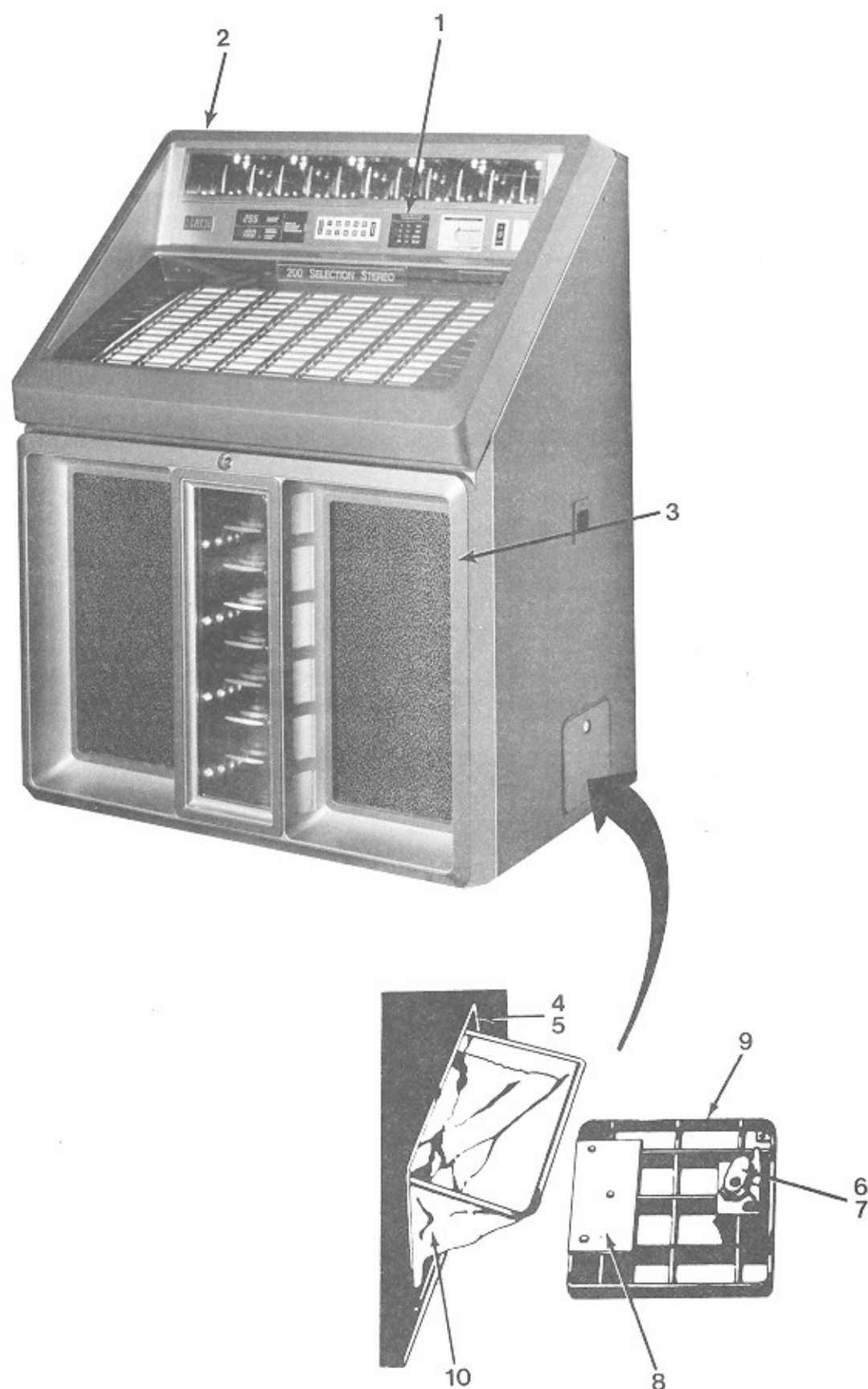

FIG. AND INDEX NO.	ROWE PART NO.	DESCRIPTION	QTY. PER ASSY
1-	See pg. 7-2	R-90 Phonograph Assembly (Blue)	
	See pg. 7-2	R-90 Phonograph Assembly (Brown)	
1	3-09016-01	. Standard Price Card.....	1
2	6-09910-01	. Top Door (Blue).....	1
	6-09910-02	. Top Door (Brown).....	1
3	6-09920-01	. Front Door (Blue).....	1
	6-09920-02	. Front Door (Brown).....	1
4	4-05276-05	. Cash Box Door Frame.....	1
5	2-17760-05	. "U" Type Speed Clip.....	1
	2-11866-05	. Cash Box Door Assembly.....	1
6	7-01600-16	. Cylinder Lock.....	1
7	2-06695-01	. Lock Support.....	1
8	2-07703-01	. Catch Bracket.....	1
9	6-03267-05	. Cash Box Door.....	1
10	3-07026-01	. Cash Bag.....	1
	7-02125-07	. Felt Adhesive Tape.....	1
	4-08008-01	. Holder Price Card	1
	2-18456-07	. Window When Bill } Acceptor Is Not Used Not Shown	1
	4-08025-01	. Overlay - Blockout	1

FIGURE  
1

# R-90 PHONOGRAPH ASSEMBLY SHEET 2

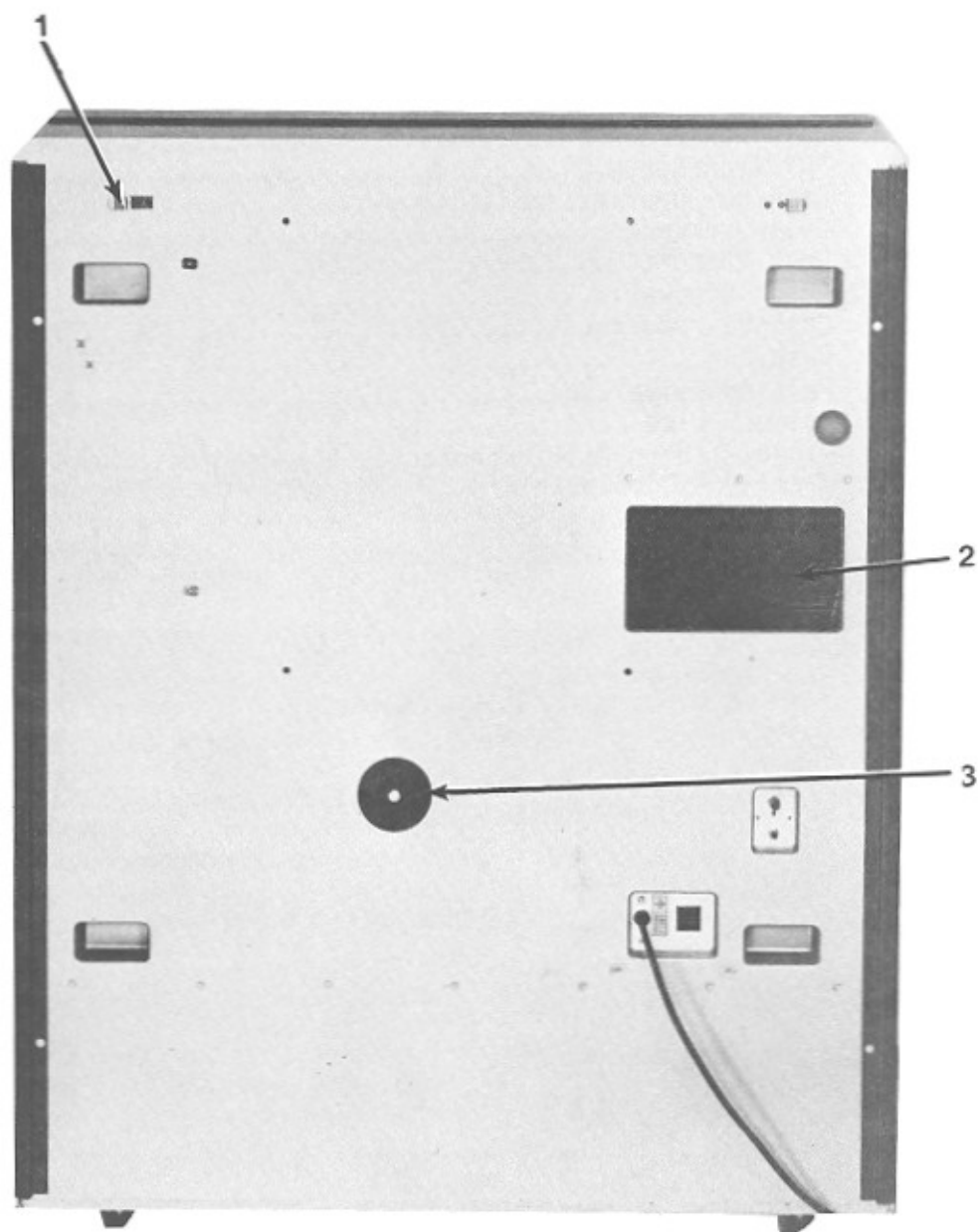

FIG. AND INDEX NO.	ROWE PART NO.	DESCRIPTION	QTY. PER ASSY
-----------------------------	---------------------	-------------	---------------------

- |    |             |                                  |   |
|----|-------------|----------------------------------|---|
| 1- | See pg. 7-2 | R-90 Phonograph Assembly (Cont.) |   |
|    | See pg. 7-2 | R-90 Phonograph Assembly (Cont.) |   |
| 1  | 2-08995-02  | . Retainer Bracket.....          | 2 |
| 2  | 3-08684-02  | . Enclosure Screen.....          | 1 |
| 3  | 2-12652-03  | . Tie Down Plate Assembly.....   | 1 |



# R-90 PHONOGRAPH ASSEMBLY SHEET 3

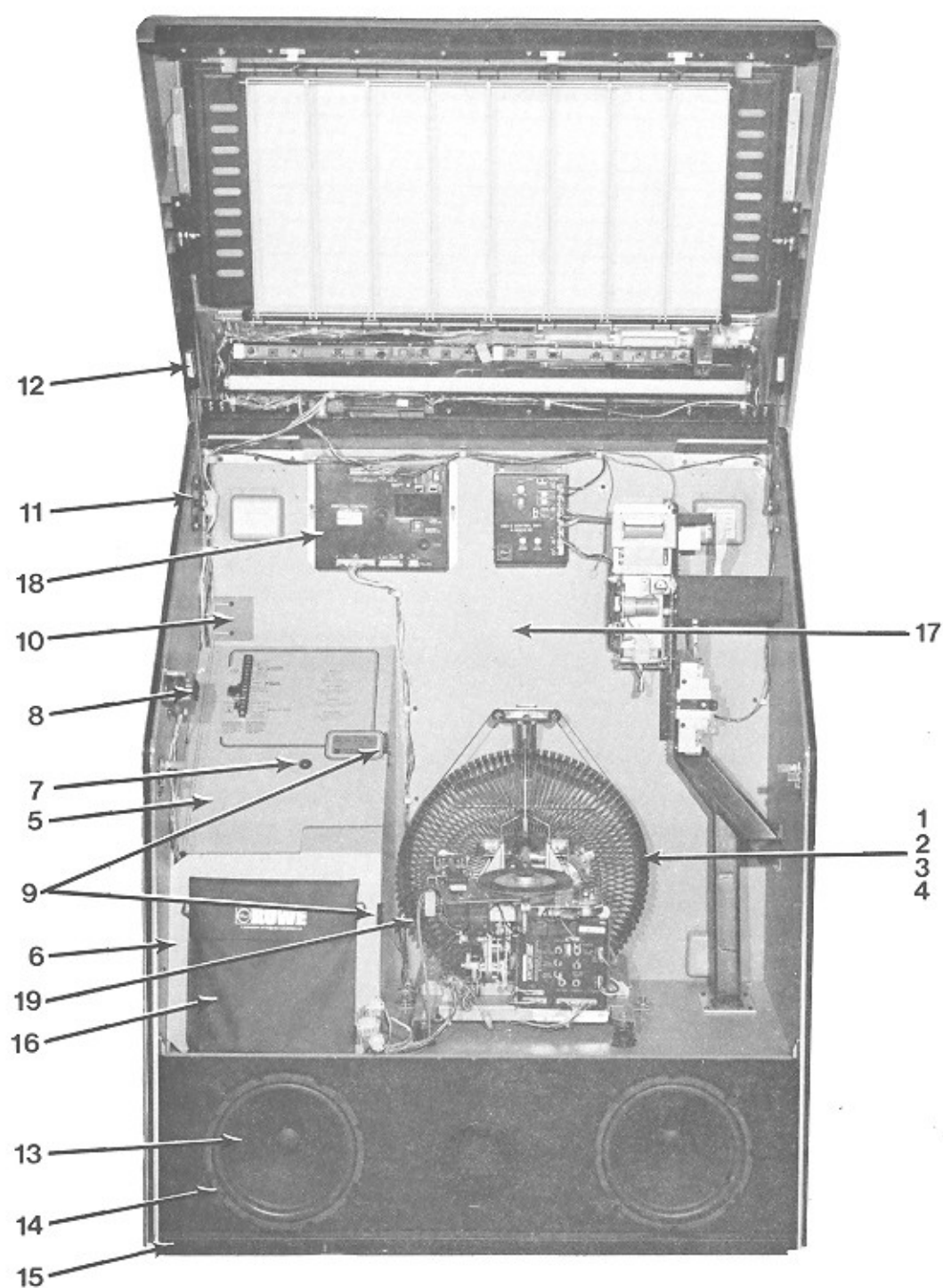



FIG. AND INDEX NO.	ROWE PART NO.	DESCRIPTION	QTY. PER ASSY
-1	See Pg. 7-2	R-90 Phonograph Assembly (Blue) Cont.	
-1	See Pg. 7-2	R-90 Phonograph Assembly (Brown) Cont.	
1	6-08700-01	. Mechanism Assembly (See Fig. 11)(60Hz).....	1
2	6-08700-02	. Mechanism Assembly (See Fig. 11)(50Hz).....	1
3	2-11537-01	. Lower Spring Support.....	4
4	2-12036-01	. Mech Tie Down Bolt.....	2
5	4-07726-05	. Hinge & Cover Assembly.....	1
6	3-08697-02	. Amplifier Panel Assembly.....	1
7	2-18880-01	. Catch - Hook.....	1
8	2-18881-01	. Catch - Loop.....	1
9	2-17518-04	. Spring Catch.....	2
10	2-17593-01	. Cord Hold Cover.....	2
11	2-18911-01	. Plate Assembly Pivot.....	2
12	4-07149-06	. Pneumatic Spring.....	2
13	4-07821-03	. Woofer.....	2
14	2-17807-01	. Speaker Retaining Bracket.....	8
15	6-09911-01	. Door Mounting Bracket.....	1
16	3-08698-01	. Handy Case .....	1
	2-17305-14	. . Accessory Bag Assembly.....	1
	2-11988-01	. . . Accessories Bag.....	1
	7-00975-01	. . . Contact (Pin).....	6
	7-00975-02	. . . Contact (Socket).....	6
	7-00756-01	. . . Contact (Post).....	10
	7-00910-12	. . . Terminal Lug.....	10
	7-00720-10	. . . Fuse (5 Amp).....	2
	7-00721-06	. . . Fuse (5 Amp).....	2
	3-07922-01	. . . Turntable Drive Belt.....	1
	2-18700-01	. . . Snap-in Fastener.....	2
	3-09016-02	. . Alternate Price Card.....	1
	2-18633-01	. . Lamp & Envelope Assembly.....	1
	2-18622-01	. . . Lamp & Socket Assembly.....	5
	2-66908-10	. . Troubleshooting Aid.....	1
	2-66931-09	. . Accessories Booklet.....	1
	2-14043-02	. . Heat Label.....	1
17	6-09950-01	. Shell Assembly.....	1
	6-09950-02	. Shell Assembly.....	1
18	4-07773-05	. Central Control Computer (See Fig. 9).....	1
19	3-08324-02	. Tone Arm Cable & Plug Assembly.....	1

# R-90 PHONOGRAPH ASSEMBLY SHEET 4

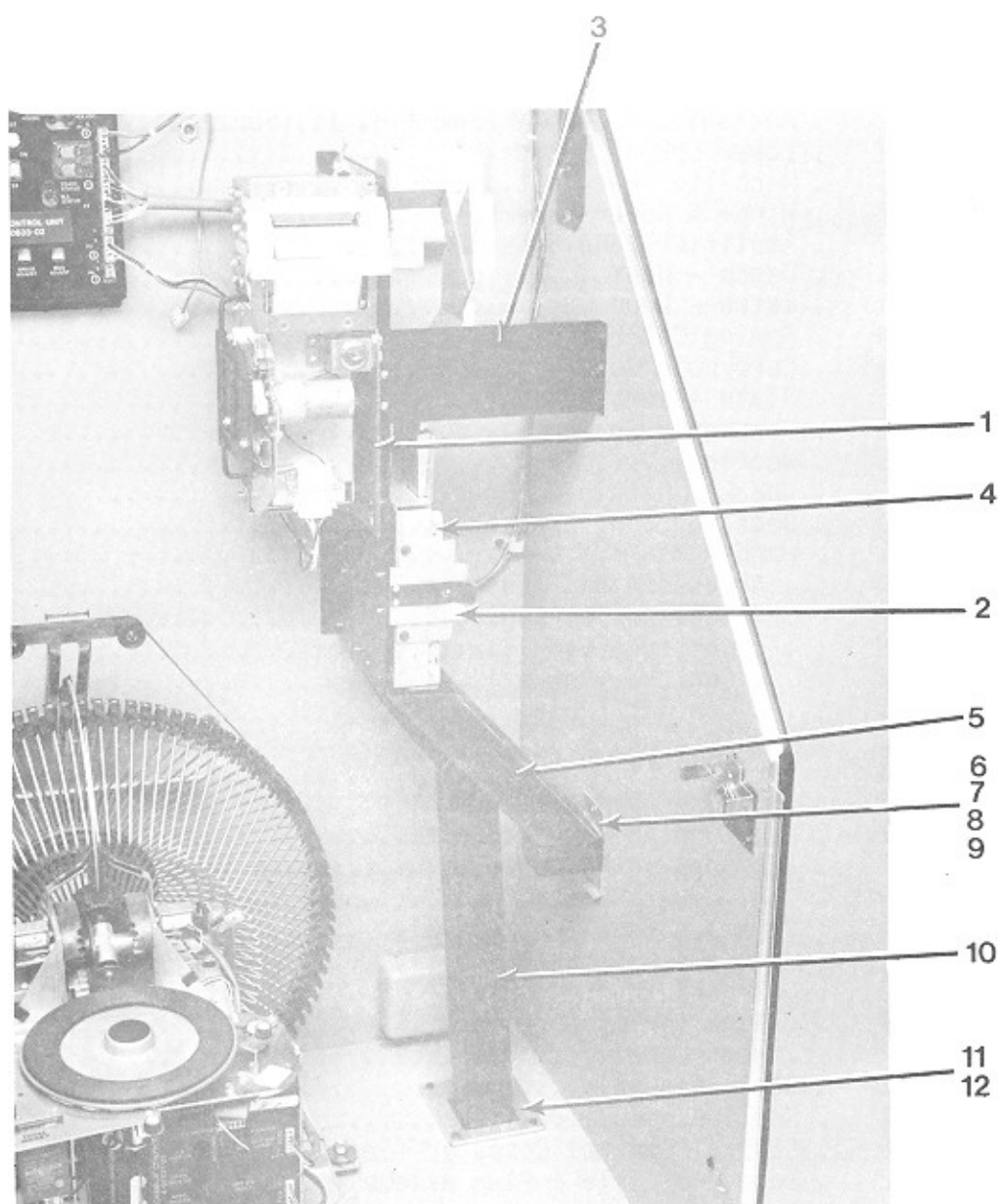

FIG. AND INDEX NO.	ROWE PART NO.	DESCRIPTION	QTY. PER ASSY
-1	See Pg. 7-2	R-90 Phonograph Assembly (Blue) Cont.	
-1	See Pg. 7-2	R-90 Phonograph Assembly (Brown) Cont.	
1	4-08012-01	. Support & Coin Chute Assembly.....	1
	3-09044-01	. . Support Assembly - Slug Rejector.....	1
	3-09045-01	. . Pivot Scavenge.....	1
	2-51569-04	. . Shoulder Washer.....	1
	2-12562-01	. . Tension Spring.....	1
	2-18918-01	. . Scavenge Link.....	1
	2-18919-01	. . Slug Rejector Actuator.....	1
	2-17656-01	. . Compression Spring.....	1
	2-09225-02	. . Spacer.....	4
	3-09046-01	. . Upper Coin Chute Assembly.....	1
	2-17901-02	. . Hinge Support.....	1
2	2-14295-01	. . Rejector Catch Assembly.....	1
3	3-09058-01	. Support Brace.....	1
4	4-07038-10	. Mounting Bracket & Coin Switch Assembly.....	1
	4-05793-02	. . Slug Rejector Mounting Bracket Assembly.....	1
	2-14114-01	. . Spacer.....	1
	3-05787-03	. . Coin Switch Assembly.....	1
	2-17902-02	. . Rejector Hinge.....	1
	2-06368-01	. . Stud.....	1
	2-18223-01	. . Slug Rejector Catch Plate.....	1
5	4-08015-01	. Slug Chute.....	1
6	2-17930-01	. Slug Cup Bracket.....	2
7	2-13578-02	. Elastic Stop Nut.....	1
8	2-17929-01	. Slug Cup Door.....	1
9	3-07817-02	. Slug Cup.....	1
10	6-09932-01	. Lower Coin Chute.....	1
11	3-07437-01	. Coin Chute Collar.....	1
12	2-17544-01	. Coin Chute Gasket.....	1

FIGURE  
1

# R-90 PHONOGRAPH ASSEMBLY SHEET 5

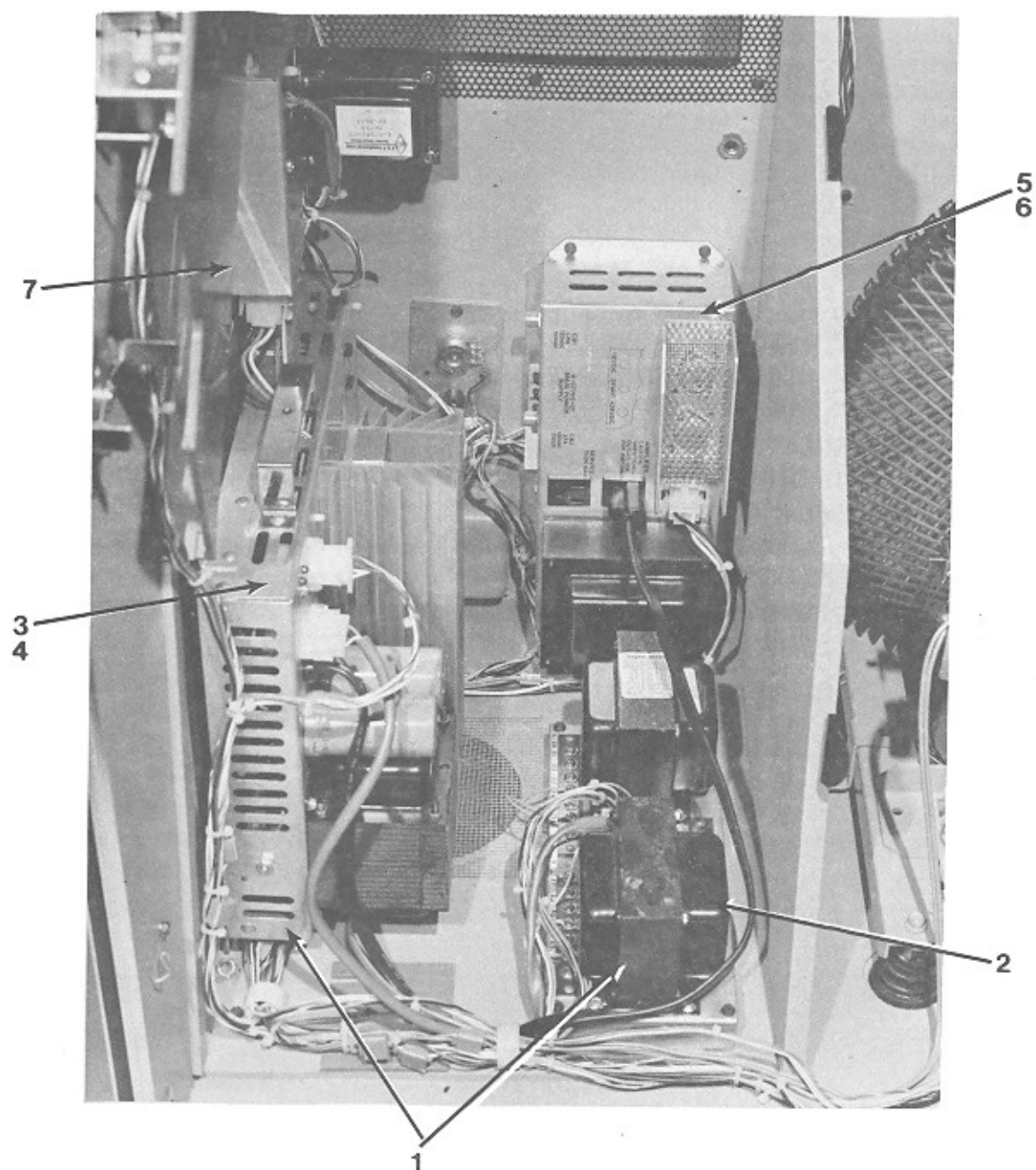

FIG. AND INDEX NO.	ROWE PART NO.	DESCRIPTION	QTY. PER ASSY
-1	See pg. 7-2	R-90 Phonograph Assembly (Blue) Cont.	
-1	See pg. 7-2	R-90 Phonograph Assembly (Brown) Cont.	
1	6-09941-01	. 130 Watt Stereo Amplifier and Transformer Assembly.....	1
2	4-06336-05	. 125 Watt Output Transformer Assembly (See Fig. 8).....	1
3	6-09931-01	. 130 Watt Stereo Amplifier (See Fig. 6).....	1
4	4-02426-01	. Amplifier Mounting Bracket Assembly.....	1
5	4-07706-01	. Main Power Supply (120V)(See Fig. 10).....	1
	4-65092-02/03	. Main Power Supply (220V, 240V).....	1
6	2-09256-01	. Junction Box Mounting Bracket.....	1
7	4-07501-03	. Lamp Control Assembly (See Fig. 5).....	1

# R-90 PHONOGRAPH ASSEMBLY SHEET 6

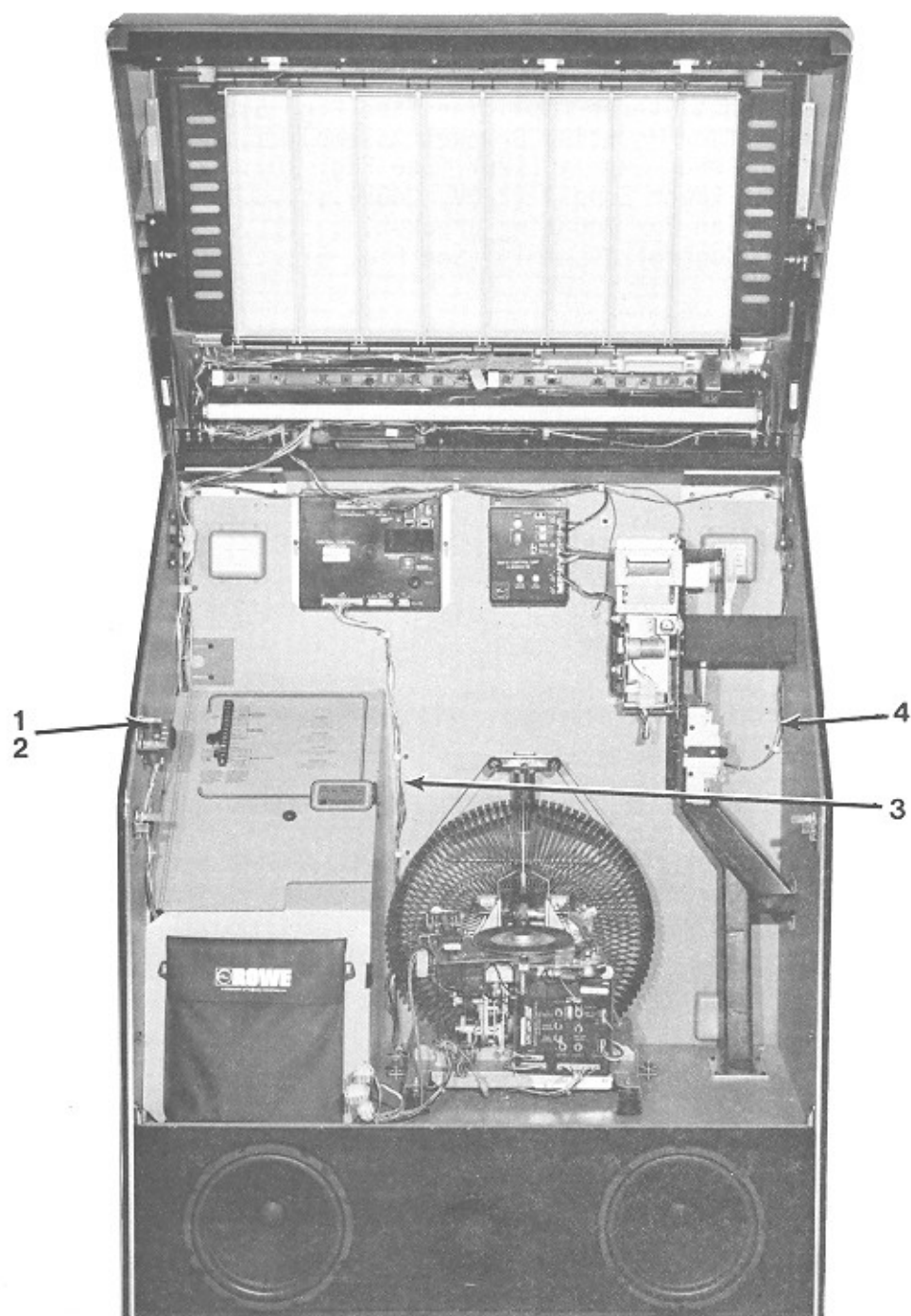

FIG. AND INDEX NO.	ROWE PART NO.	DESCRIPTION	QTY. PER ASSY
-1	See Pg. 7-2	R-90 Phono Assembly (Blue) Cont.	
-1	See Pg. 7-2	R-90 Phono Assembly (Brown) Cont.	
1	6-09912-01	. Harness & Switch Assembly.....	1
	3-07491-05	. . Housing Plug (9 Ckt.).....	2
	3-07491-08	. . Housing Plug (1 Ckt.).....	1
	3-07491-04	. . Housing Plug (6 Ckt.).....	1
	7-00755-09	. . Housing Connector (9 Ckt.).....	1
	7-00755-05	. . Housing Connector (5 Pin).....	4
	3-07491-03	. . Housing Plug (4 Ckt.).....	1
	3-07491-02	. . Housing Plug (3 Ckt.).....	3
	3-06490-02	. . Housing Plug (3 Ckt.).....	2
	7-00975-06	. . Contact - Univ. Conn. (Socket).....	6
	7-00975-01	. . Contact - Univ. Conn. (Pin).....	11
	7-00975-02	. . Contact - Univ. Conn. (Socket).....	10
	7-00975-03	. . Contact - Univ. Conn. (Pin).....	7
	7-00757-01	. . Keying Plug.....	1
	2-18005-01	. . Jumper.....	1
	2-18686-01	. . Knob - Vol. Control.....	1
	7-01355-11	. . Palnut (3/8 - 32).....	1
	2-13935-08	. . Vol. Control & Terminal Assembly.....	1
	2-15818-01	. . Switch Pushbutton (Momentary).....	1
	2-18680-01	. . Plate - Control.....	1
	7-00991-01	. . Splice Self Stripping.....	14
	7-00975-06	. . Contact - Univ. Conn. (Socket).....	3
	7-00967-03	. . Insulator Faston.....	2
2	2-18837-01	. Reset Actuator Assembly.....	1
3	3-08854-01	. Mech. Computer Harness.....	1
4	3-09023-01	. Coin Switch Harness Assembly.....	1



FIGURE  
2

## FRONT DOOR ASSEMBLY

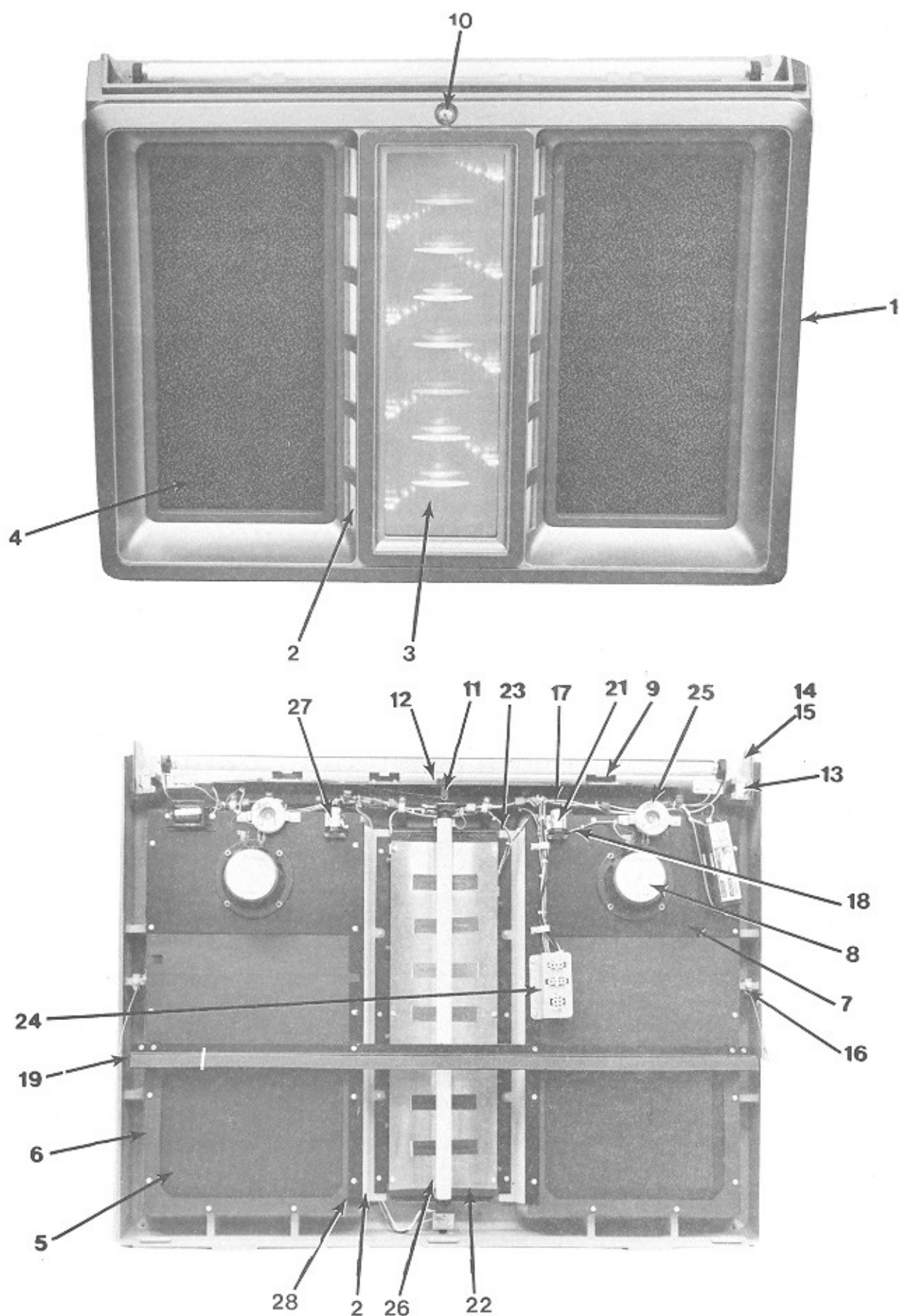

FIG. AND INDEX NO.	ROWE PART NO.	DESCRIPTION	QTY. PER ASSY
2-	6-09920-01	Front Door Assembly (Blue)	
	6-09920-02	Front Door Assembly (Brown)	
1	6-09916-01	. . Front Door Frame (Blue).....	1
1	6-09916-02	. . Front Door Frame (Brown).....	1
2	3-09018-01	. . Light Diffuser (Magenta).....	2
2	3-09018-02	. . Light Diffuser (Orange).....	2
3	2-18217-03	. . Light Bar Window.....	1
4	4-08019-01	. . Lower Grille.....	2
5	4-08035-01	. . Front Door Scrim.....	2
6	3-09019-01	. . Grille Back Up.....	2
7	3-09020-01	. . Speaker Panel Assembly.....	2
8	4-07822-02	. . Midrange Speaker (High Freq).....	2
9	6-09918-01	. . Lock Bar Assembly.....	1
10	7-01632-06	. . Lock Cylinder (Common Keying).....	1
11	2-14256-01	. . Lock Bolt.....	1
12	2-18935-01	. . Lockbolt Link.....	1
13	2-18835-03	. . Strike.....	2
14	2-18937-01	. . Anti-Cheat Bracket LH.....	1
15	2-18938-01	. . Anti-Cheat Bracket RH.....	1
16	2-15726-01	. . Fall Stop Cable.....	2
	3-09021-01	. . . Front Door Speaker Harness Label (Not Shown).....	1
17	4-08020-01	. . Front Door Light Harness Assembly (60 Hz).....	1
18	4-08021-01	. . Front Door Speaker Harness Assembly.....	1
19	3-09039-01	. . Seal Bracket.....	1
	7-02204-60	. . . Foamed Tape.....	1
	7-02204-79	. . . Foamed Tape.....	3
20	7-00601-12	. . Fluorescent Lamp (30W T-8).....	1
21	7-00800-04	. . Fluorescent Starter (FS-4).....	1
22	6-09926-01	. . Lightbox Assembly (Blue).....	1
	6-09926-02	. . Lightbox Assembly (Brown).....	1
23	4-08011-01	. . Front Door Flashing Lights Harness Assembly.....	1
24	3-09043-01	. . Mounting Bracket (Universal Connector).....	1
25	3-09049-01	. . Speaker Coil and Bracket Assembly.....	2
26	7-00601-07	. . Fluorescent Lamp (19W T-8).....	1
27	7-00800-01	. . Fluorescent Starter (FS-2).....	1
28	3-09069-01	. . Light Diffuser Retainer.....	2
	7-00934-01	. . . Cable Clamp (17/32).....	6
29	3-09073-01	. . Baffle Panel (Sound).....	1
30	3-09074-01	. . Light Reflector.....	1

FIGURE  
3

# TOP DOOR ASSEMBLY SHEET 1

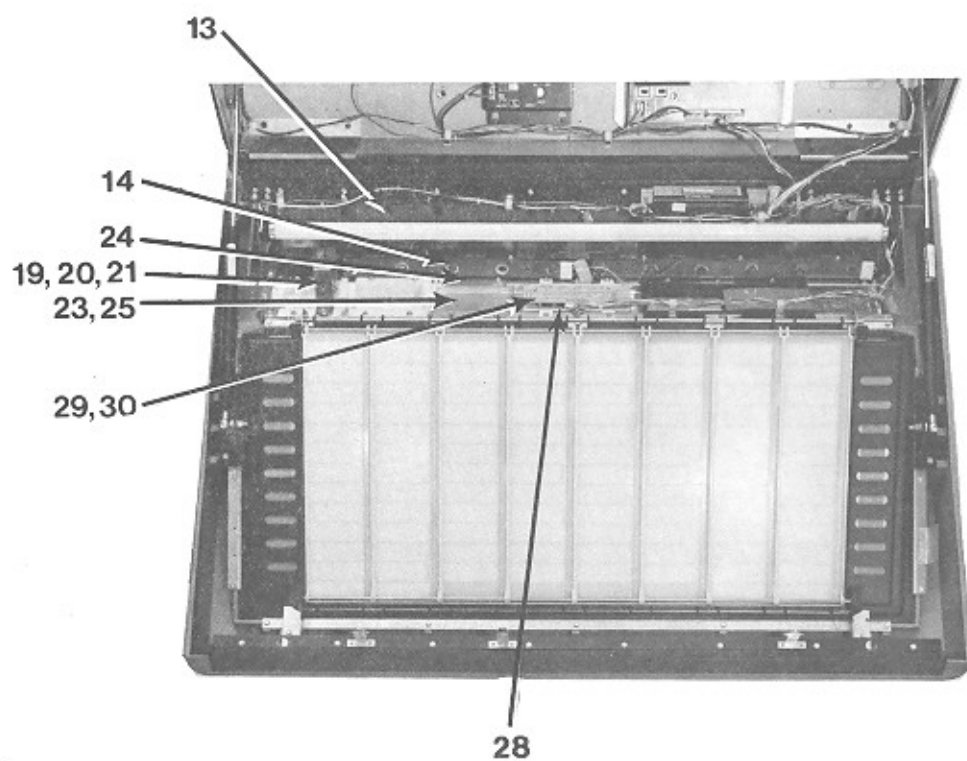
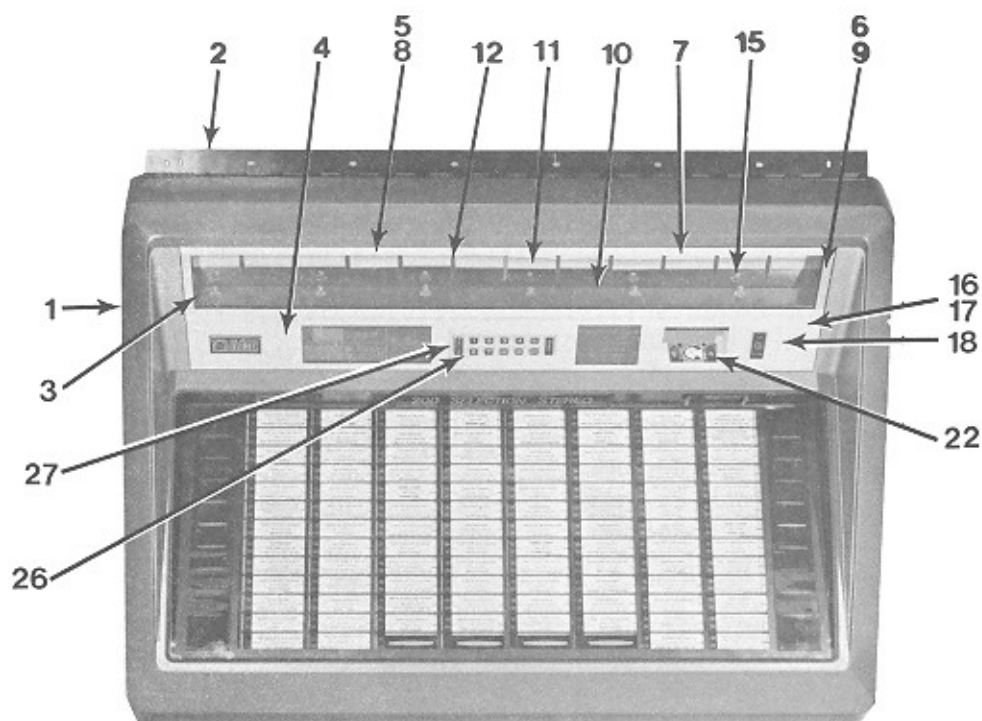

FIG. AND INDEX NO.	ROWE PART NO.	DESCRIPTION	QTY. PER ASSY
	6-09910-01	Top Door Assembly	
	6-09910-02	Top Door Assembly	
1	6-09902-01	. Top Door Frame (Blue).....	1
	6-09902-02	. Top Door Frame (Brown).....	1
2	4-07823-02	. Hinge.....	1
3	6-09903-01	. Light Assembly Top Door Flash (Blue).....	1
	6-09903-02	. Light Assembly Top Door Flash (Brown).....	1
4	4-08003-01	. . Trim Light Bar Lower (Silver).....	1
	4-08003-02	. . Trim Light Bar Lower (Gold).....	1
5	4-08004-01	. . Trim Light Bar Upper (Silver).....	1
	4-08004-02	. . Trim Light Bar Upper (Gold).....	1
6	4-08005-01	. . Trim Light Bar Side (Silver).....	2
	4-08005-02	. . Trim Light Bar Side (Gold).....	2
7	2-18456-06	. . Window.....	1
8	2-18206-17	. . Channel.....	2
9	2-18206-18	. . Channel.....	2
10	6-09933-01	. . Frame Assembly Flashing Lights.....	1
11	6-09935-01	. . Mirror - Top Door.....	1
12	6-09936-01	. . Color Strip (Blue).....	1
	6-09936-02	. . Color Strip (Brown).....	1
13	6-09929-01	. . PWB - 6 Lamp.....	2
14	2-18622-01	. . Lamp and Socket Assembly.....	12
15	3-08665-03	. . Lens - Clear.....	12
16	6-09904-01	. Selector & Trim Assembly Blue (Silver).....	1
	6-09904-02	. Selector & Trim Assembly Brown (Gold).....	1
17	6-09907-01	. . Trim Selector (Silver).....	1
	6-09907-02	. . Trim Selector (Gold).....	1
18	4-08006-01	. . Inlet - Coin.....	1
19	2-17429-08	. . Reject Button & Shaft Assembly.....	1
	2-18922-01	. . . Coin Return Shaft.....	1
	3-06996-09	. . . Coin Return Button.....	1
20	3-09050-01	. . Guide Bracket.....	1
21	2-18229-01	. . Compression Spring.....	1
22	2-18933-01	. . Bill Inlet Assembly.....	1
23	4-08008-01	. . Price Card Holder.....	1
24	2-18928-01	. . Retainer.....	1
25	2-18456-07	. . Window.....	1
26	4-07453-03	. . Pushbutton Trim.....	1
27	4-08009-01	. . Keyboard Assembly.....	1
28	4-08036-01	. . . Keyboard Support Plate.....	1
29	6-09921-01	. . . PWB Keyboard.....	1
30	3-08371-01	. . . Keyboard Switch.....	12

# TOP DOOR ASSEMBLY

## SHEET 2

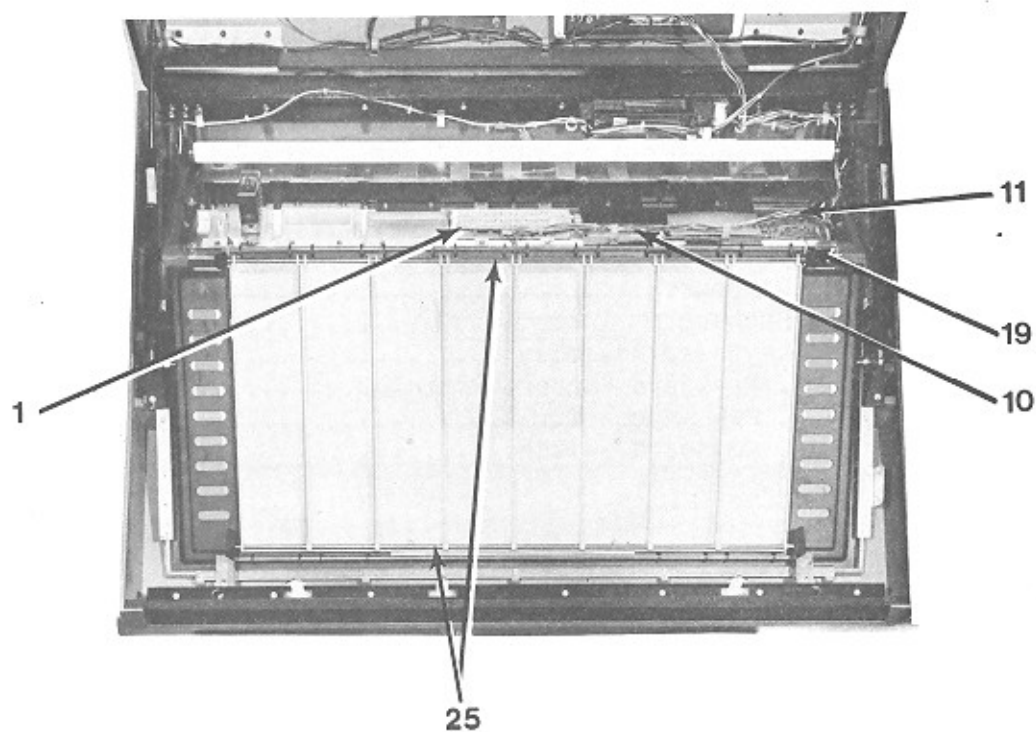
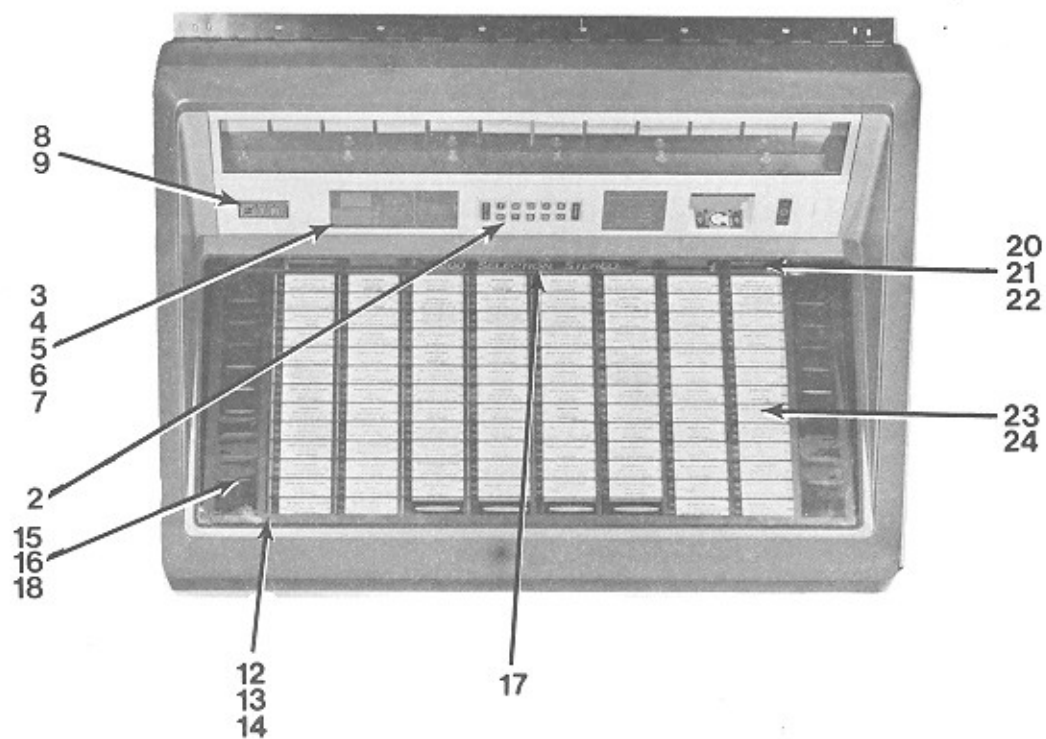



FIG. AND INDEX NO.	ROWE PART NO.	DESCRIPTION	QTY. PER ASSY
1	7-00797-13	. . . Connector PCB.....	1
2	3-09034-01	. . . Pushbutton Number 1.....	1
	3-09034-02	. . . Pushbutton Number 2.....	1
	3-09034-03	. . . Pushbutton Number 3.....	1
	3-09034-04	. . . Pushbutton Number 4.....	1
	3-09034-05	. . . Pushbutton Number 5.....	1
	3-09034-06	. . . Pushbutton Number 6.....	1
	3-09034-07	. . . Pushbutton Number 7.....	1
	3-09034-08	. . . Pushbutton Number 8.....	1
	3-09034-09	. . . Pushbutton Number 9.....	1
	3-09034-10	. . . Pushbutton Number 10.....	1
	3-09035-01	. . . Pushbutton Popular.....	1
	3-09036-01	. . . Pushbutton Reset.....	1
3	4-08010-01	. . Readout Holder.....	1
4	3-09024-01	. . Readout Card.....	1
5	2-18456-08	. . Window.....	1
6	6-09928-01	. . Circuit Board Assembly Digital Display.....	1
7	2-18936-01	. . Light Block.....	1
8	2-18450-02	. . Rowe Nameplate.....	1
9	2-15328-01	. . Push-on Speednut.....	2
10	3-09065-01	. . Harness Assembly Digital Display.....	1
11	3-09008-01	. . Harness Assembly - Keyboard.....	1
12	7-02122-06	. Sponge Rubber Closed Cell.....	2
13	7-02122-07	. Sponge Rubber Closed Cell.....	2
14	2-18456-05	. Window.....	1
15	6-09905-01	. Title Rack Housing Assembly.....	1
16	6-09908-01	. . Title Rack Housing.....	1
17	3-09011-01	. . Decal Selections.....	1
18	6-09909-01	. . Decorative Decal (Blue).....	2
	6-09909-02	. . Decorative Decal (Brown).....	2
19	3-09012-01	. . Title Rack Hanger Assembly LH.....	1
	3-09013-01	. . Title Rack Hanger Assembly RH.....	1
20	3-08866-01	. . License Holder.....	2
21	2-18807-01	. . License Retainer.....	2
22	7-01355-08	. . Palnut.....	4
23	4-08000-01	. Title Rack Assembly.....	1
24	6-07571-02	. . Title Rack.....	8
	3-09014-01	. . Number Strip 100-212.....	1
	3-09014-02	. . Number Strip 113-225.....	1
	3-09014-03	. . Number Strip 126-237.....	1
	3-09014-04	. . Number Strip 138-249.....	1
	3-09014-05	. . Number Strip 150-261.....	1
	3-09014-06	. . Number Strip 162-273.....	1
	3-09014-07	. . Number Strip 174-286.....	1
	3-09014-08	. . Number Strip 182-299.....	1
25	2-17944-17	. . Rod.....	2
	7-01430-03	. . External Retaining Ring.....	2
	2-15689-01	. . Push Nut.....	2
	2-18846-02	. . Decorative Strip.....	4

# TOP DOOR ASSEMBLY SHEET 3

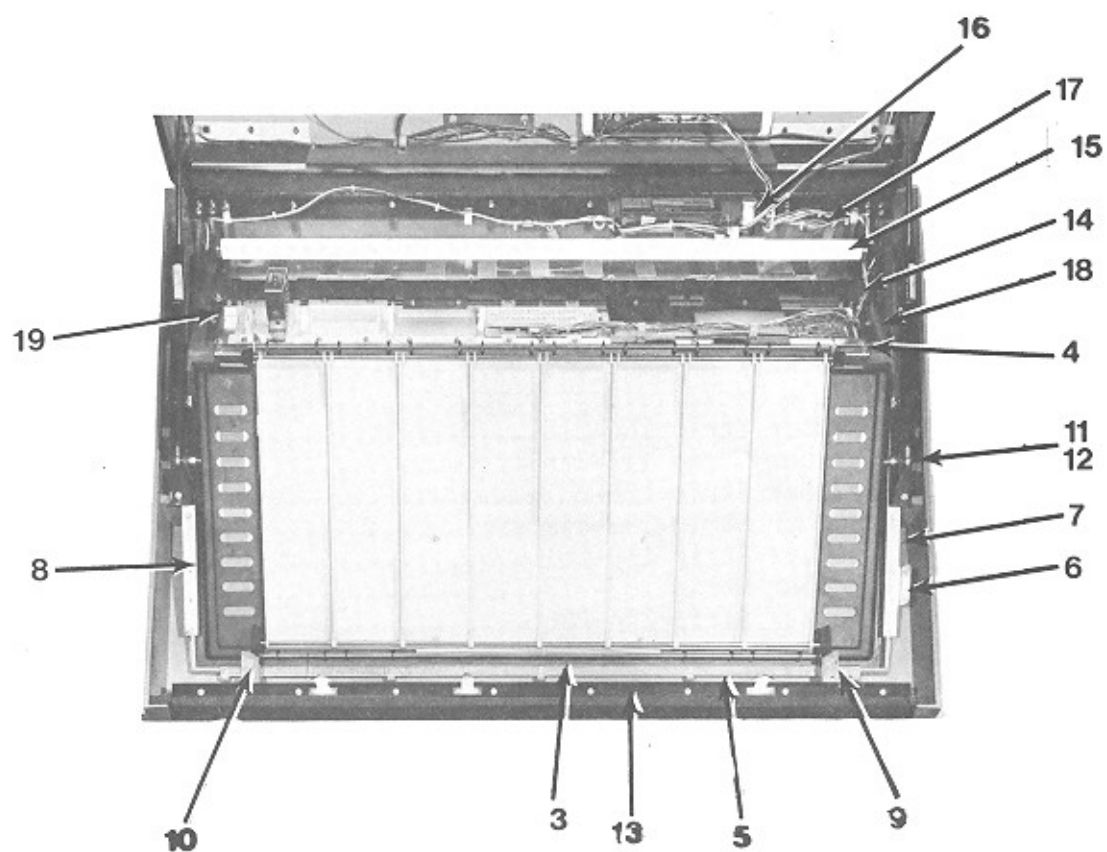
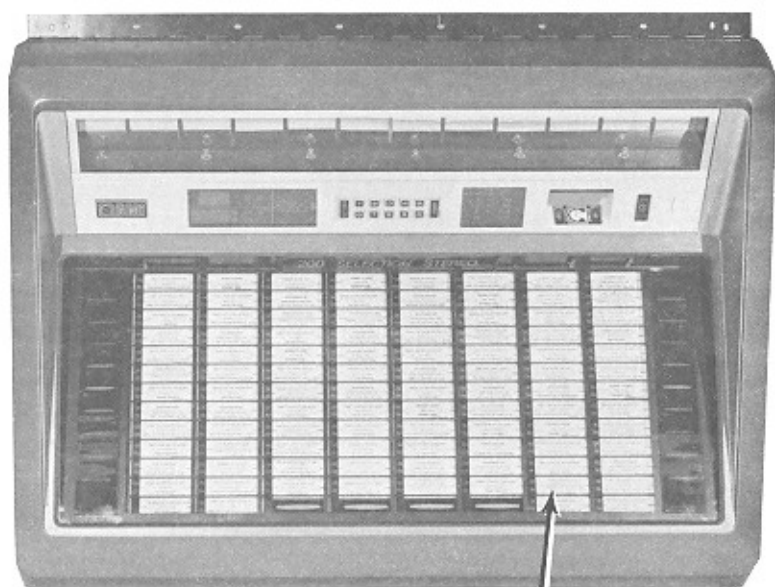



FIG. AND INDEX NO.	ROWE PART NO.	DESCRIPTION	QTY. PER ASSY
1	4-08001-01	. Title Blockout Assembly.....	1
2	6-09817-01	. . Title Blockout.....	4
3	2-17944-17	. Rod.....	2
	7-01430-03	. . External Retaining Ring.....	1
	2-15689-01	. . Push Nut.....	1
4	3-09001-01	. Upper Shroud Retainer.....	1
5	3-09002-01	. Lower Shroud Retainer.....	1
6	2-18924-01	. Actuator Bracket.....	1
7	3-09056-01	. Shroud Retainer LH.....	1
8	3-09057-01	. Shroud Retainer RH.....	1
9	2-18900-01	. Catch Assembly LH.....	1
10	2-18901-01	. Catch Assembly RH.....	1
11	3-09029-01	. Door Support.....	2
12	2-17976-01	. Ball Stud.....	2
13	3-09004-01	. Trim & Catch Assembly.....	1
14	3-09007-01	. Flashing Light Harness Assembly.....	1
	7-00766-03	. . Edge Connector.....	2
	7-00755-06	. . Connector Housing.....	1
	7-08001-01	. . Cable Tie.....	22
15	7-00601-12	. Fluorescent Lamp.....	1
16	7-00800-04	. Fluorescent Starter.....	1
17	4-08002-01	. Light Harness Assembly (60 Hz).....	1
	3-08594-01	. . Ballast (30W 60 Hz).....	1
	3-09053-01	. . Lamp Bracket LH.....	1
	3-09054-01	. . Lamp Bracket RH.....	1
	3-09055-01	. . Ballast Bracket.....	1
	2-18267-19	. . Fluorescent Lamp Holder.....	2
	2-00295-01	. . Starter Socket.....	1
	3-07491-02	. . Plug Housing (3 Pin).....	1
	7-08001-01	. . Cable Tie.....	20
	7-00991-01	. . Self Stripping Splice.....	2
	7-00993-01	. . Self Stripping Splice 2-Way.....	5
18	3-09075-01	. Light Block LH.....	1
19	3-09076-01	. Light Block RH.....	1

**FIGURE**  
**4**

# OEM BILL ACCEPTOR

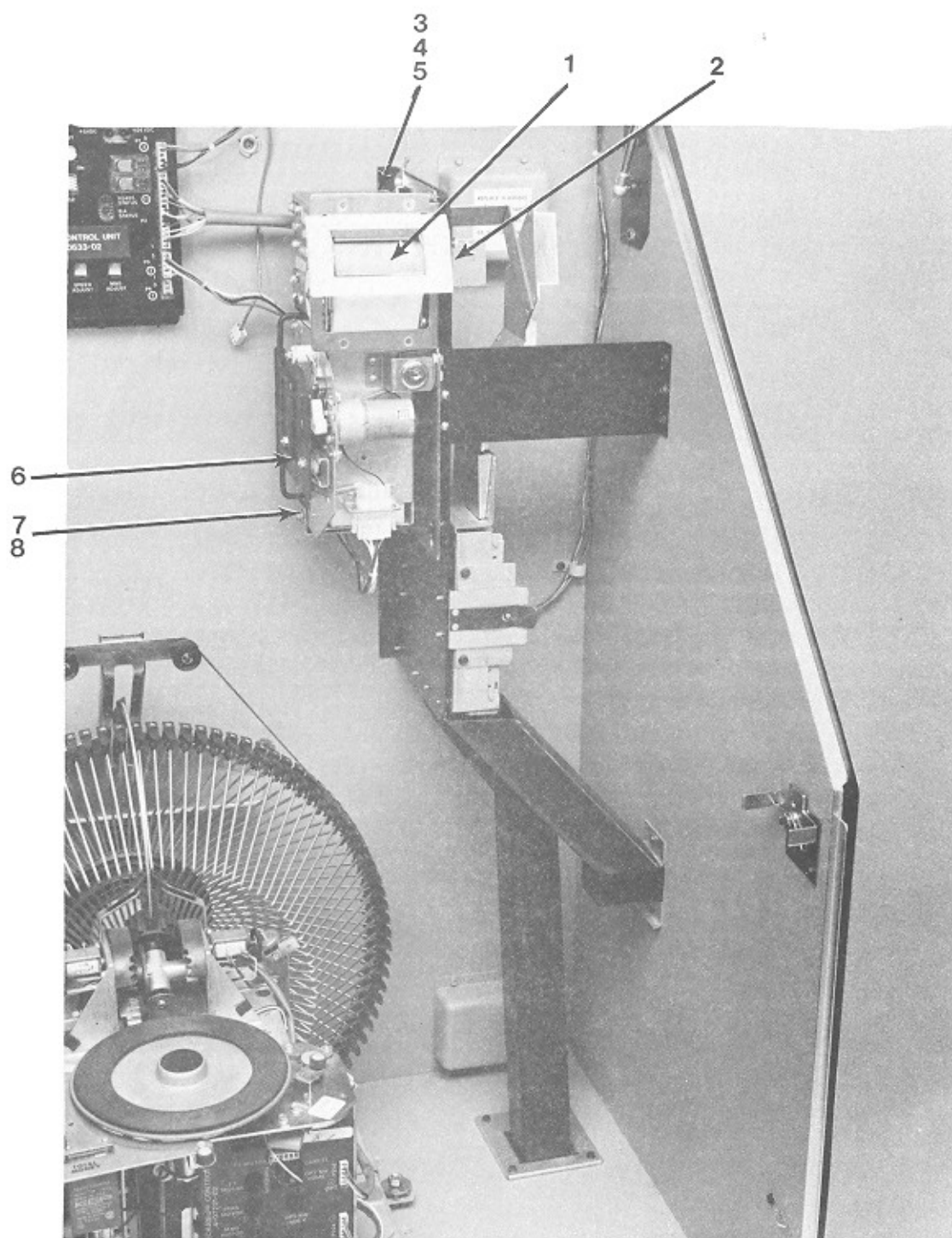

FIG. AND INDEX NO.	ROWE PART NO.	DESCRIPTION	QTY. PER ASSY
-4	6-50570-22	OEM Bill Acceptor Kit Factory Installed (See Fig. 15)	
-4	6-50570-23	OEM Bill Acceptor Kit Field Installed (See Fig. 15)	
-4	6-09915-02	Transport & Stacker Assembly (OBA-2)	
1	6-50565-12	. Transport Assembly - OBA (R-90).....	1
2	4-08023-01	. Phono Shroud (OBA).....	1
3	4-08039-01	. Bracket & Support Assembly.....	1
4	2-15358-05	. Plastic Nut (Self-Retaining).....	1
5	2-18930-01	. Lock Plate Assembly.....	1
6	6-07979-03	. OBA Stacker Assembly (300 Bill).....	1
7	2-15347-08	. Pivot Pin.....	1
8	7-01430-04	. External Retaining Ring.....	1

**FIGURE  
5**

# **LIGHT DISPLAY CONTROL**

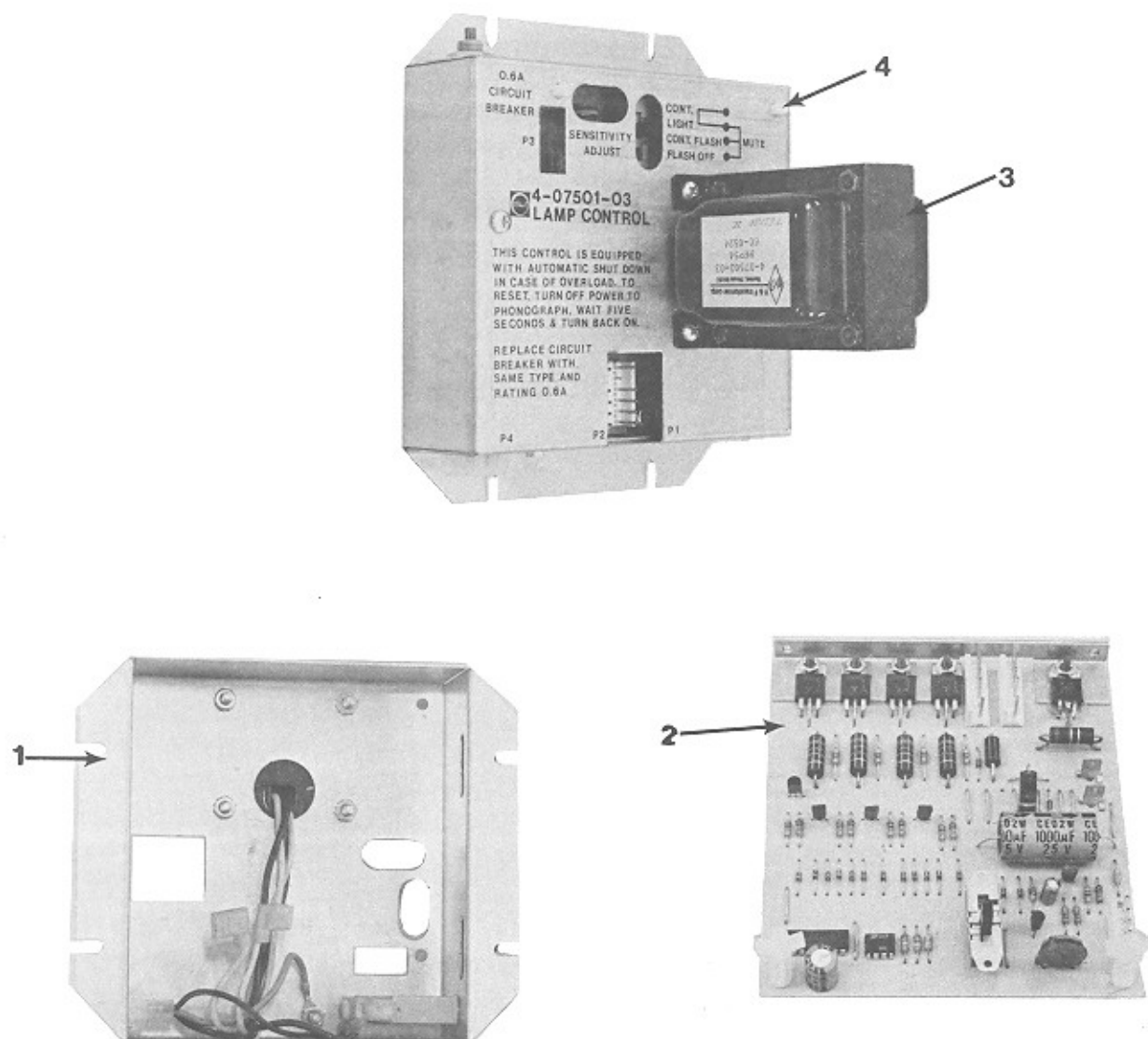

FIG. AND INDEX NO.	ROWE PART NO.	DESCRIPTION	QTY. PER ASSY
5-	4-07501-03	Light Display Controller Assembly	
1	4-07500-03	. Cover .....	1
2	6-09255-03	. Circuit Board Assembly.....	1
3	4-07502-03	. Transformer .....	1
4	7-05000-13	. Circuit Board Support.....	1

# SHELL ASSEMBLY

FIG. AND INDEX NO.	ROWE PART NO.	DESCRIPTION	QTY. PER ASSY
6-09950-01		Shell Assembly (Blue)	
6-09950-02		Shell Assembly (Brown)	
2-15372-01		. Teenut (Mechanism Tie Down).....	2
2-17506-12		. Vent Tube.....	1
2-17506-15		. Vent Tube.....	1
7-02401-26		. Wire Mesh Screen.....	1
3-06257-01		. Hand Hole Cover.....	4
2-14518-01		. Lock Spring.....	1
3-06340-01		. Caster & Cup Assembly.....	4
4-07802-07		. Skid Rail.....	2
2-09326-01		. Teenut.....	2
6-09279-01		. Cash Bag Bracket.....	1

**FIGURE 6**

# STEREO AMPLIFIER SYSTEM ASSEMBLY

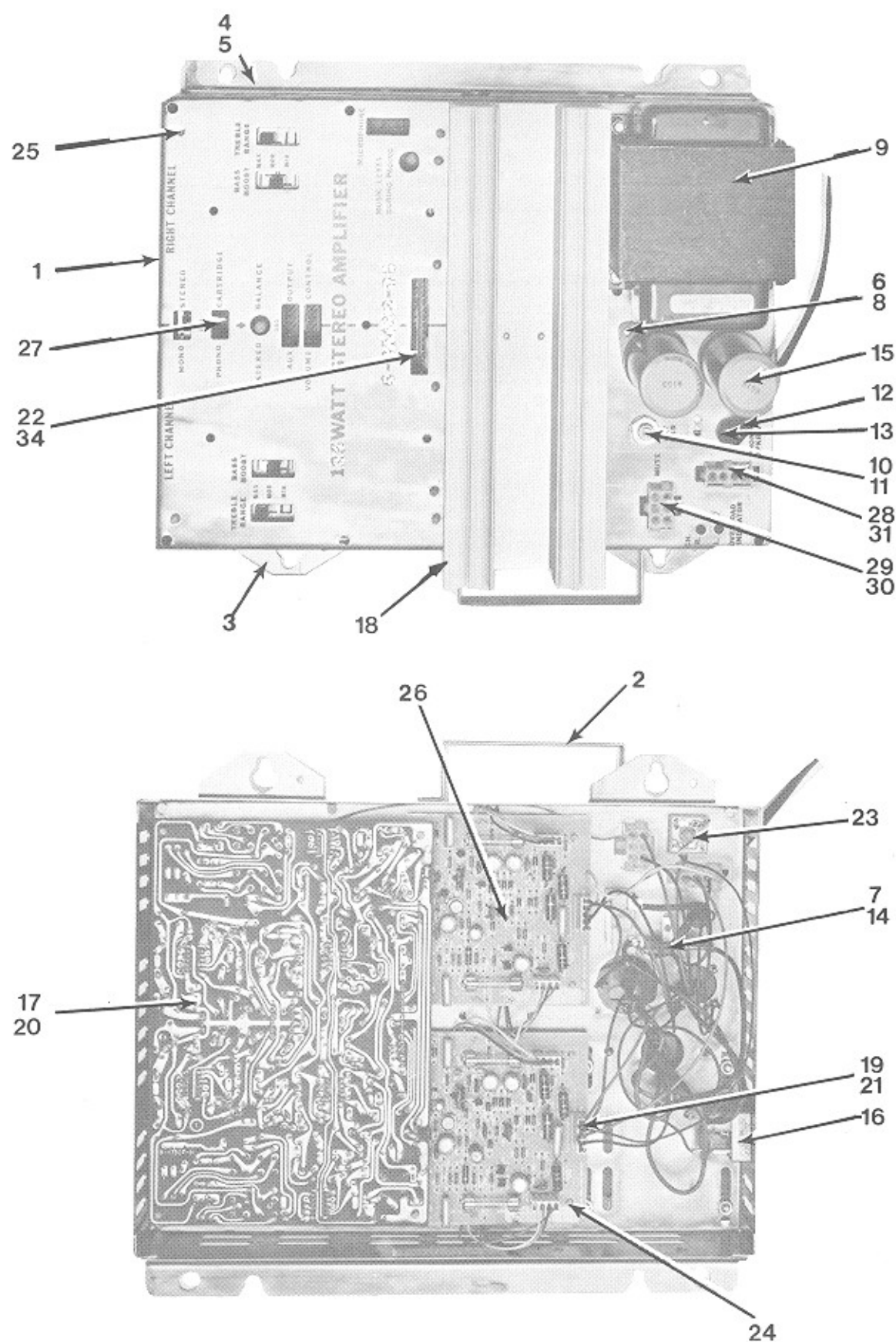

FIG. AND INDEX NO.	ROWE PART NO.	DESCRIPTION	QTY. PER ASSY
6-	6-09931-01	Stereo Amplifier Assembly (Figure 1, Sheet 5, Item 5)	
1	6-07441-07	. Chassis Assembly.....	1
2	2-14881-01	. Handle.....	1
3	2-09272-01	. Mounting Bracket.....	2
4	3-06273-01	. Mounting Bracket.....	1
5	7-01113-20	. Semi Tubular Rivet.....	10
6	2-13910-01	. Mounting Wafer.....	1
7	2-17241-02	. Terminal Strip.....	1
8	7-01110-07	. Semi Tubular Rivet.....	2
9	4-07378-04	. Power Transformer.....	1
10	7-00789-17	. Circuit Breaker.....	1
11	7-01220-11	. Washer.....	1
12	2-52186-03	. 3 Conductor Cord & Plug.....	1
13	7-02322-05	. Strain Relief.....	1
14	7-00213-05	. Mylar Capacitor.....	1
15	2-18231-01	. Electrolytic Capacitor.....	2
16	2-18225-01	. Bridge Rectifier.....	1
17	6-07925-04	. Stereo Preamp. Assembly (See Schem. for Parts List).....	1
18	4-07151-03	. Heat Sink Assembly (See Figure 7).....	1
19	7-00755-05	. Connector Housing (5 Ckt.).....	2
20	7-00755-02	. Connector Housing (2 Ckt.).....	1
21	7-00756-01	. Post Contact.....	11
22	7-00755-13	. Connector Housing (13 Ckt.).....	1
23	2-18934-01	. Speaker Overload Ind. (Right Channel).....	1
	2-18934-02	. Speaker Overload Ind. (Left Channel).....	1
24	7-05000-04	. Circuit Board Support.....	8
25	7-05000-18	. Circuit Board Support.....	4
26	4-07101-03	. Driver Circuit Board Assembly (See Power Amp. Schem. for P.L.)	2
27	7-00755-03	. Connector Housing (3 Ckt.).....	1
28	3-07490-03	. Cap Housing.....	1
29	3-07490-04	. Cap Housing.....	1
30	7-00975-02	. Contacts.....	8
31	2-16207-02	. Amplifier Jumper Plug Assembly.....	1



FIGURE  
7

## HEAT SINK ASSEMBLY

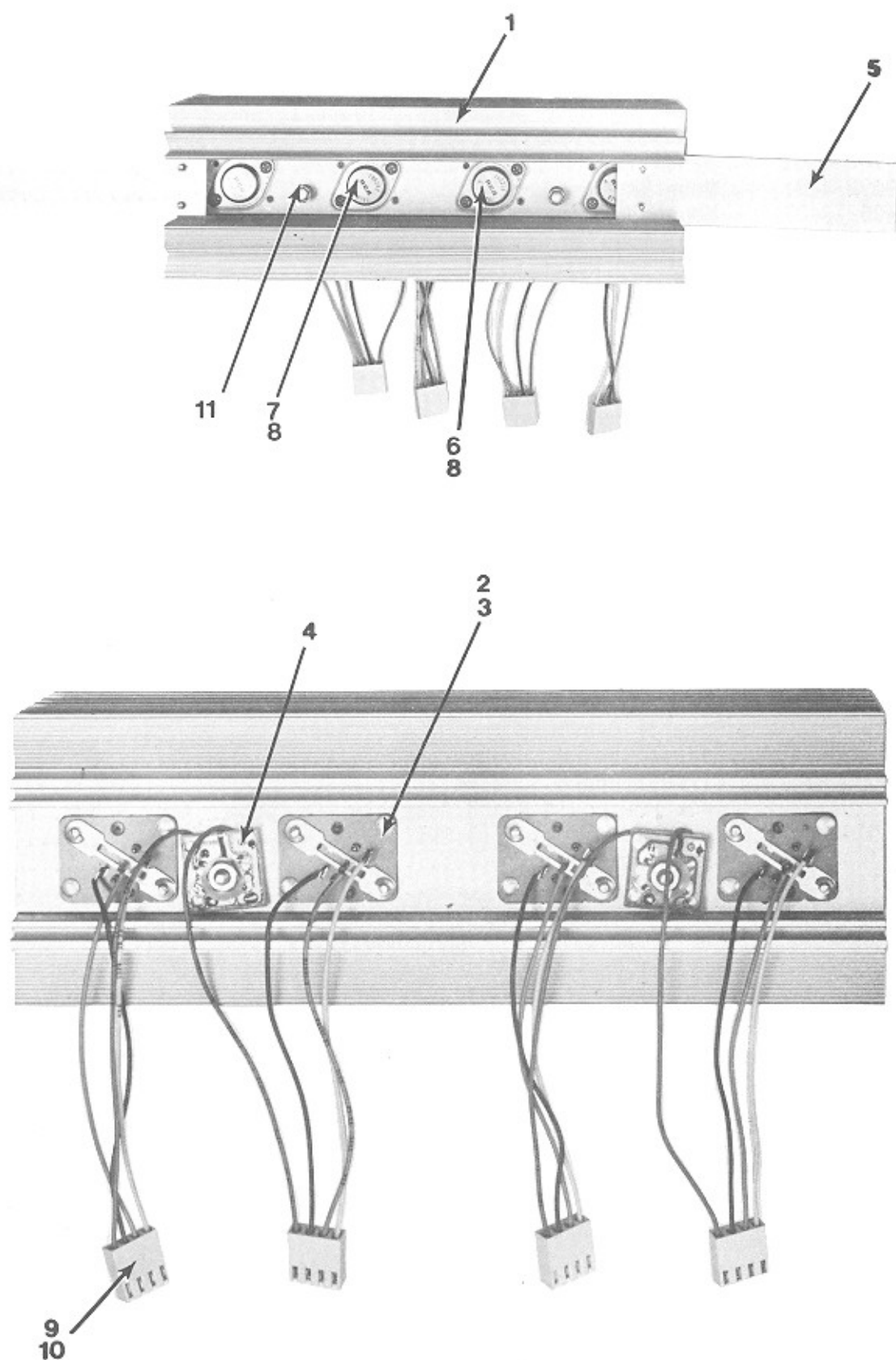

FIG. AND INDEX NO.	ROWE PART NO.	DESCRIPTION	QTY. PER ASSY
-7	4-07151-02	Heat Sink Assembly (Figure 6, Item 18)	
1	4-07103-01	. Heat Sink.....	1
2	2-15473-01	. Power Transistor Socket.....	4
3	7-01111-14	. Semi Tubular Rivet.....	8
4	3-04253-01	. Power Amp Bias Circuit Board Assembly.....	2
	4-06359-01	. . Power Amp Bias Printed Wiring Board.....	1
	7-00350-02	. . Silicon Diode.....	3
	7-00756-01	. . Post Contact.....	2
5	2-17980-01	. Cover.....	2
6	7-00302-06	. Transistor (Darlington Amp)(M-SJ6366K, RCA-2N6283).....	2
7	7-00302-07	. Transistor (Darlington Amp)(M-SJ6365K, FCA-2N6286).....	2
8	2-13189-01	. Insulator.....	4
9	7-00755-04	. Connector Housing.....	4
10	7-00756-01	. Post Contact.....	6
11	7-01200-09	. Washer.....	2
	7-01217-17	. . Spacer.....	2
	2-18402-01	. . Spring - Compression.....	2

FIGURE  
8

# OUTPUT TRANSFORMER ASSEMBLY

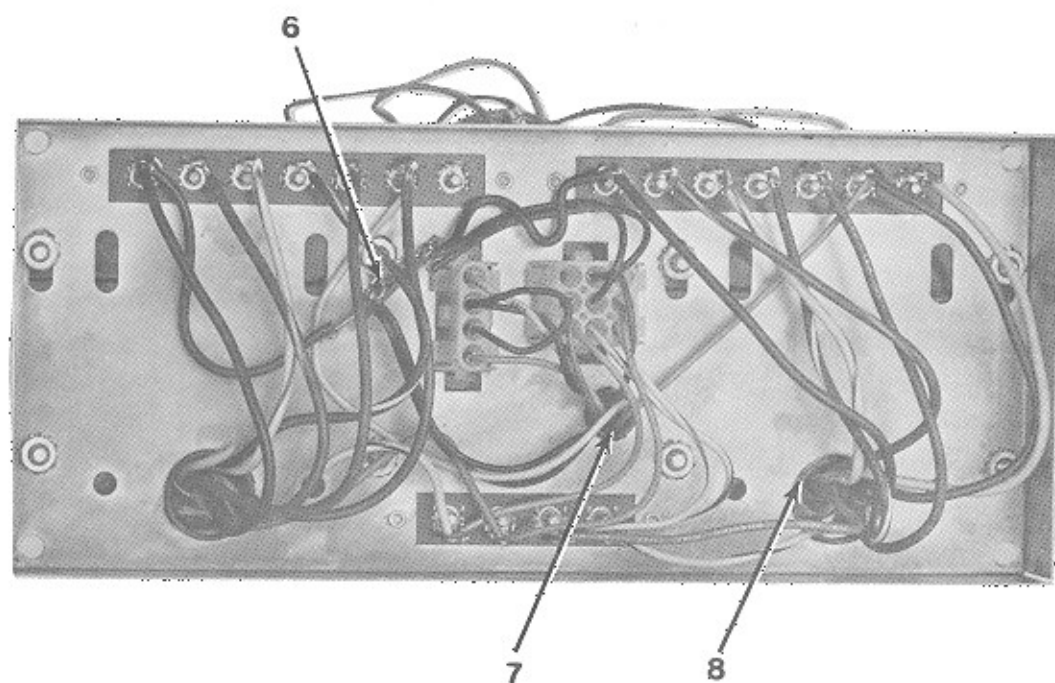
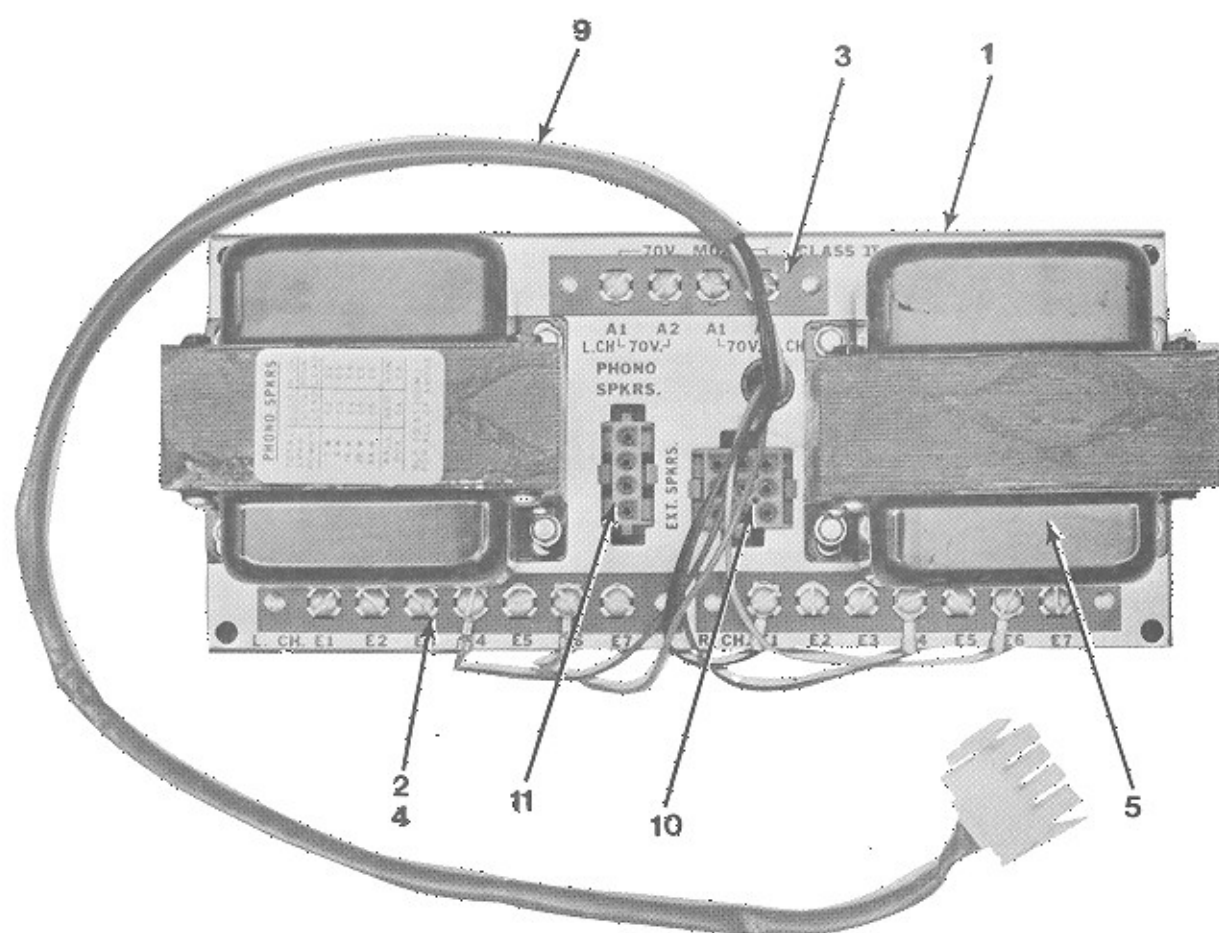

FIG. AND INDEX NO.	ROWE PART NO.	DESCRIPTION	QTY. PER ASSY
-8	4-06336-05	Output Transformer Assembly (Figure 1, Sheet 5, Item 2)	
1	3-06260-07	. Output Chassis.....	1
2	3-04267-05	. Binding Post Strip.....	2
3	3-04267-03	. Binding Post Strip.....	1
4	7-01110-07	. Semi Tubular Rivet.....	6
5	4-06335-01	. Output Transformer.....	2
6	3-04225-14	. Terminal Strip.....	1
7	7-02331-01	. Insulating Bushing.....	1
8	7-02331-02	. Insulating Bushing.....	2
9	2-15323-05	. Plug & Cable Assembly.....	1
	3-07491-03	. . Plug Housing.....	1
	7-00975-01	. . Contact (Pin).....	4
10	3-07488-01	. Plug & Cable Assembly.....	1
	3-07490-05	. . Cap Housing (9 Ckt.).....	1
	7-00975-02	. . Contact.....	8
	7-00910-12	. . Spade Terminal Lug.....	2
11	2-15373-04	. Plug & Cable Assembly.....	1
	7-00910-12	. . Spade Terminal Lug.....	3
	3-07490-03	. . Cap Housing.....	1
	7-00975-02	. . Contact.....	4

FIGURE  
9

# CENTRAL CONTROL COMPUTER

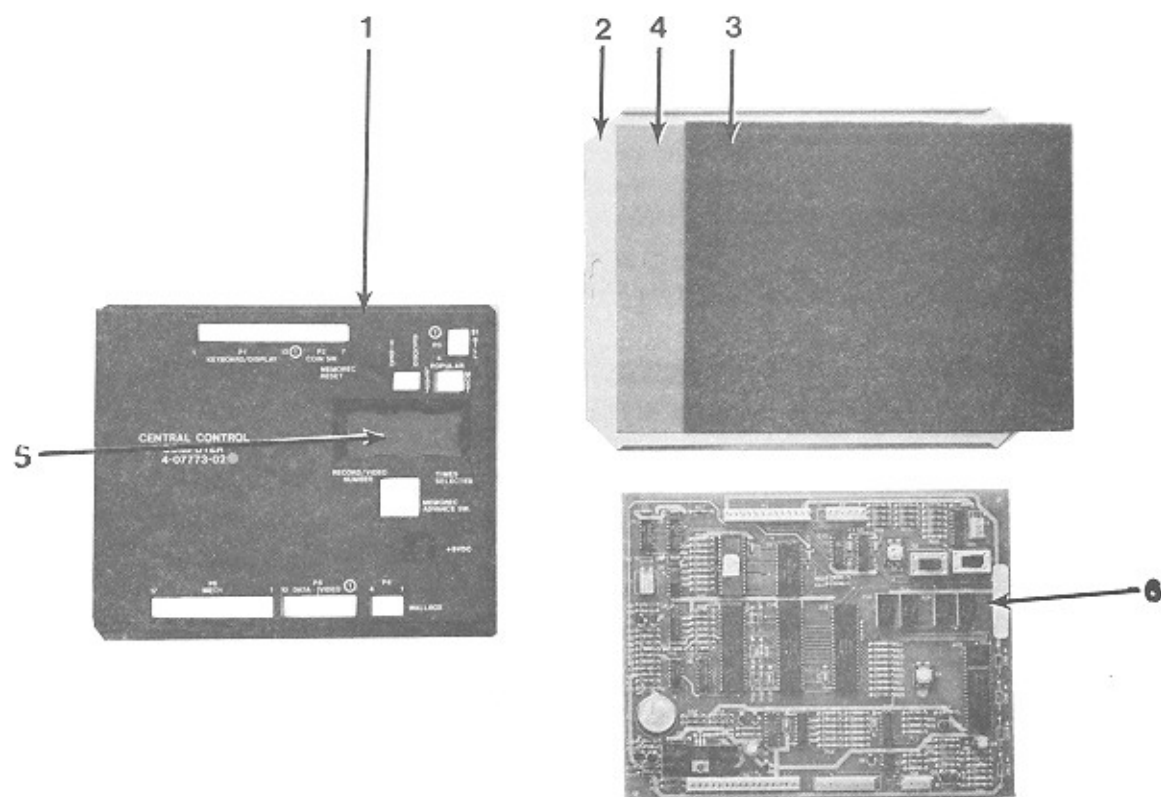

FIG. AND INDEX NO.	ROWE PART NO.	DESCRIPTION	QTY. PER ASSY
9-	4-07773-05	Central Control Computer Assembly.....	1
1	4-07792-03	. Central Control Computer Cover.....	1
2	4-07791-01	. Central Control Computer Base.....	1
3	2-17710-14	. Insulator Pad.....	1
4	2-17711-11	. Insulation Base.....	1
5	2-17819-05	. Light Filter Display Card.....	1
6	6-09738-05	. Central Computer Circuit Board Assembly.....	1

**FIGURE**  
**10**

# MAIN POWER SUPPLY (120V MODEL)

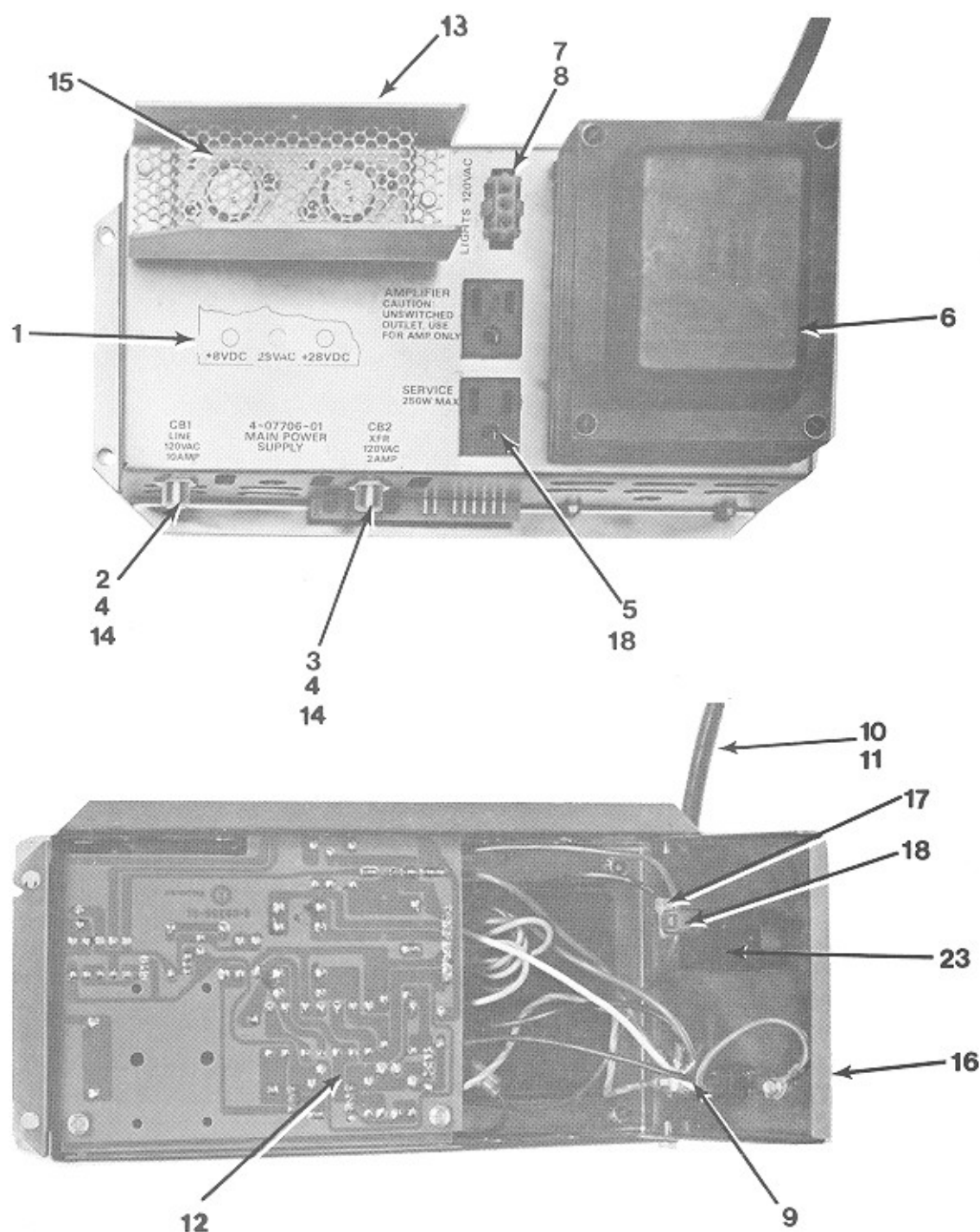



FIG. AND INDEX NO.	ROWE PART NO.	DESCRIPTION	QTY. PER ASSY
-10	4-07706-03	Main Power Supply (120V) (Figure 1, Sheet 5, Item 5)	
	4-65092-05	Main Power Supply (220V)	
	4-65092-06	Main Power Supply (240V)	
1	4-07719-02	. Chassis Assembly.....	1
2	7-00734-25	. 10 Amp Circuit Breaker.....	1
3	7-00733-15	. 2 Amp Circuit Breaker.....	1
4	7-01220-01	. Washer (Internal Lock) Part of Breaker.....	2
5	2-13759-01	. 3 Wire Convenience Outlet.....	2
6	4-07720-01	. Transformer & Harness Assembly.....	1
	4-07720-26	. . Power Transformer (120V).....	1
	4-65093-26	. . Power Transformer (220V-240V).....	REF
	7-00756-01	. . Post Contact.....	6
	7-00756-01	. . Post Contact (220V-240V).....	5
	7-00975-04	. . Contact.....	1
	7-00913-08	. . Terminal Lug.....	1
	7-00913-08	. . Terminal Lug (220V-240V).....	4
7	3-07490-02	. Cap Housing.....	1
	7-00975-04	. . Contact (220V-240V).....	3
8	7-00975-04	. Contact (120V).....	2
	7-00913-08	. . Terminal Lug (120V).....	2
	7-00913-08	. . Terminal Lug (220V-240V).....	4
9	7-00915-11	. Ring Terminal.....	2
10	3-08345-06	. Power Cord Assembly (120V).....	1
	3-65365-01	. . Power Cord Assembly (220V-240V).....	1
11	7-02321-04	. Strain Relief.....	1
12	6-09357-02	. Circuit Board Assembly.....	1
13	4-07331-02	. Heat Sink and Power Transistor Assembly.....	1
	3-08343-01	. . Power Supply Heat Sink.....	1
	7-00308-07	. . Transistor (Darlington)(2N6055)(Motorola, RCA).....	2
	2-13189-01	. . Insulator.....	2
	2-18342-01	. . Power Transistor Socket.....	2
	7-00755-04	. . Connector Housing.....	2
	7-00756-01	. . Post Contact.....	6
	7-00757-02	. . Keying Post.....	2
14	2-14086-02	. Straight Receptacle (120V).....	4
	2-14086-02	. Straight Receptacle (220V-240V).....	8
	7-00734-21	. Breaker 220/240 (5A)(Not Shown).....	2
	7-00734-22	. Breaker 220/240 (6A)(Not Shown).....	1
15	2-18281-01	. Heat Sink Cover.....	1
16	3-08673-01	. Switch Panel.....	1
17	7-00967-01	. Insulated Faston (120V).....	4
	7-00967-01	. Insulated (220V-240V).....	3
18	7-00992-01	. Self Stripping Terminal.....	5
19	7-00991-01	. Self Stripping Terminal.....	1
20	7-00755-08	. Connector Housing (Not Shown).....	1
21	7-00757-02	. Keying Plug (Not Shown).....	1
22	7-00756-01	. Post Contact (120V)(Not Shown).....	1
	7-00756-01	. Post Contact (220V-240V).....	2
23	3-07857-01	. Rocker Switch (120V).....	1
	3-07857-02	. Rocker Switch (220V-240V).....	1
	2-17241-01	. Terminal Retainer Strip (220V-240V).....	1

# MECHANISM ASSEMBLY SHEET 1

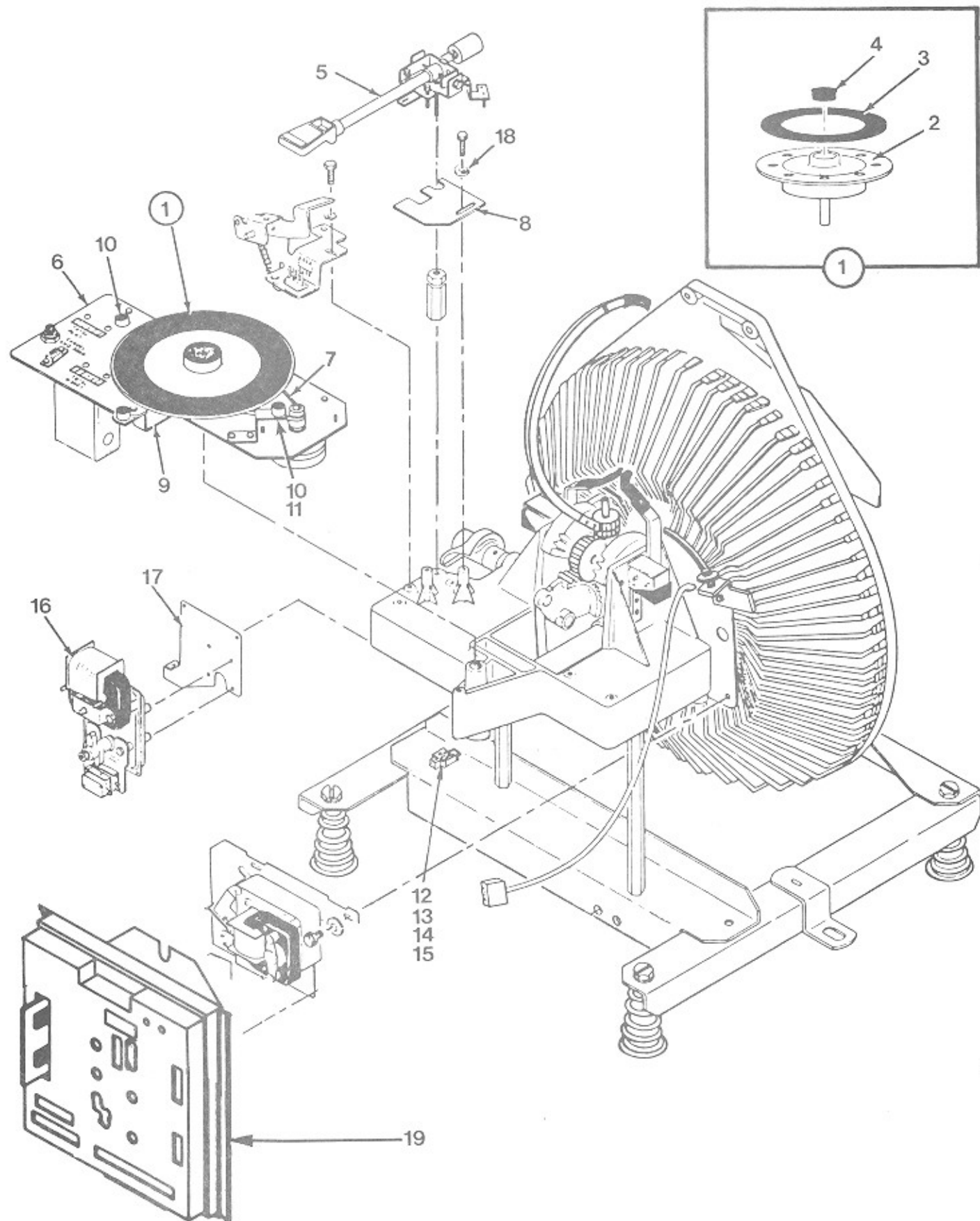

FIG. AND INDEX NO.	ROWE PART NO.	DESCRIPTION	QTY. PER ASSY
-11	6-08700-01	Mechanism Assembly (Figure 1, Sheet 3, Item 1) (60HZ)	
	6-08700-02	Mechanism Assembly (Figure 1, Sheet 3, Item 2) (50HZ)	
1	3-07921-01	. Turntable Assembly.....	1
2	4-07215-01	. Turntable & Shaft Assembly.....	1
3	3-05235-01	. Turntable Face.....	1
4	2-18163-01	. Hole Plug.....	1
5	4-07217-02	. Tone Arm & Pivot Assembly (See Figure 12).....	1
6	3-07935-01	. Plate & Counter Assembly.....	1
	2-15818-01	. . Momentary Contact Switch.....	1
	3-07942-01	. . Brush Holder.....	1
	2-02182-01	. . Brush.....	1
	4-07220-02	. . Counter Mounting Plate.....	1
	2-18137-01	. . Counter Assembly.....	1
	2-15383-02	. . . Counter.....	1
	2-14418-02	. . . Electric Counter.....	1
	7-00921-04	. . . Solderless Connector.....	4
	7-00755-05	. . . Connector Housing.....	1
	7-00756-01	. . . Post Contact.....	4
	7-00757-02	. . . Keying Plug.....	1
7	3-07922-01	. Turntable Drive Belt.....	1
8	3-07938-02	. Tone Arm Cutoff Circuit Board Assembly.....	1
	4-07225-02	. . Printed Wiring Board.....	1
	2-10726-02	. . Reed Switch.....	1
	7-00760-02	. . Polarizing Wafer 90 Degrees.....	1
	2-18181-01	. . Contact.....	1
	7-00770-01	. . Socket - Mini Spring.....	2
9	2-18188-01	. Bracket - Grommet & Rivet Assembly.....	1
10	2-18189-01	. Bracket - Grommet & Rivet Assembly.....	2
11	2-18139-01	. . Grommet.....	3
12	4-07224-01	. Mechanism Harness Assembly.....	1
	3-07490-05	. . Cap Housing (9 Ckt.).....	1
	3-00795-01	. . Contact.....	7
	3-00795-03	. . Contact.....	2
	7-00755-02	. . Connector Housing.....	1
	7-00755-08	. . Connector Housing.....	1
	7-00755-10	. . Connector Housing.....	1
	7-00756-01	. . Post Contact.....	17
	7-00757-01	. . Keying Plug.....	1
	7-00757-02	. . Keying Plug.....	2
	7-00913-02	. . Terminal Lug.....	5
	7-00913-06	. . Terminal Lug.....	2
	7-00913-08	. . Terminal Lug.....	2
	7-00913-14	. . Terminal Lug.....	9
	7-00916-02	. . Spade Terminal Lug.....	1
	7-00921-07	. . Solderless Connector.....	1
	7-08001-07	. . Cable Tie.....	20
13	2-07545-01	. Clip.....	3
14	2-05545-01	. Cable Clip.....	1
15	7-00934-01	. Cable Clamp.....	1
16	4-07208-01	. Cam Switch & Motor Assembly (See Figure 14).....	1
17	3-07907-01	. Motor Mounting Plate.....	1
18	7-01200-02	. Washer.....	1
19	4-07221-05	. Mechanism Control Unit.....	1
	3-07943-01	. . Mechanism Control Base.....	1
	2-17710-08	. . Insulating Pad.....	1
	2-17711-05	. . Insulating Base.....	1
	6-08708-05	. . Mechanism Control Circuit Bd. Ass'y. (See Schem. for P.L.)..	1
	4-07231-05	. . Cover.....	1

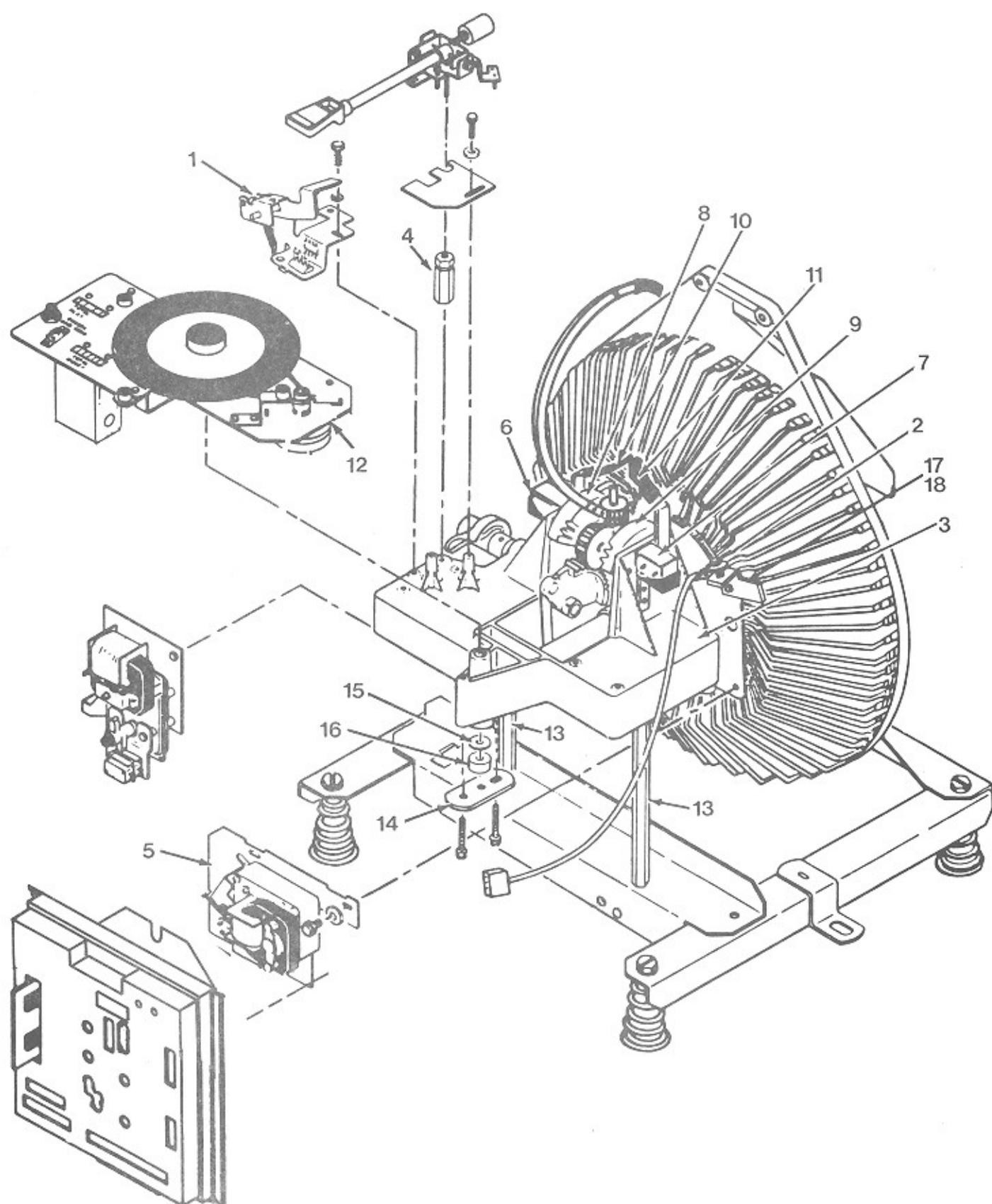

FIG. AND INDEX NO.	ROWE PART NO.	DESCRIPTION	QTY. PER ASSY
-11	6-08700-01	Mechanism Assembly (Continued)	
1	3-07926-01	. Lifting Lever & Bracket Assembly.....	1
	2-18158-01	. . Lifting Lever Bracket Assembly.....	1
	2-18159-01	. . Lifting Lever Assembly.....	1
	7-01430-05	. . Retaining Ring.....	1
	2-15760-01	. . Tension Spring.....	1
	2-18162-02	. . Grounding Clip.....	1
	7-00745-04	. . Chassis Mount Wafer (4 Ckt).....	1
	7-01111-06	. . Semi Tubular Rivet.....	1
2	3-09068-01	. Optical Switch Assembly.....	1
	3-07945-01	. . Mounting Bracket.....	1
	3-09059-01	. . Optical Switch & Connector Assembly.....	1
	4-08037-01	. . . Optical Switch.....	1
	7-00755-65	. . . Connector Housing (Red).....	1
	7-00757-02	. . . Keying Plug.....	1
	7-00756-01	. . . Contact Post.....	4
	7-08001-01	. . Cable Tie.....	2
3	7-03122-01	. Mechanism Name Plate.....	1
4	2-10708-02	. Bearing Assembly.....	1
5	4-07219-01	. Sprag Assembly (See Fig 13).....	1
6	2-18182-01	. Toggle Solenoid Assembly (L.H.).....	1
7	2-18183-01	. Toggle Solenoid Assembly (R.H.).....	1
8	3-07905-01	. Rotator Assembly (L.H.).....	1
9	3-07906-01	. Rotator Assembly (R.H.).....	1
10	2-18118-01	. Record Guide Assembly (L.H.).....	1
11	2-18119-01	. Record Guide Assembly (R.H.).....	1
12	3-07917-01	. Turntable Motor & Plate Assembly (60HZ).....	1
	3-07917-02	. Turntable Motor & Plate Assembly (50HZ).....	1
	3-07918-01	. . Turntable Motor Mounting Plate.....	1
	2-18171-02	. . Turntable Belt Guide.....	1
	3-07919-07	. . Turntable Motor Assembly (60HZ).....	1
	3-07919-08	. . Turntable Motor Assembly (50HZ).....	1
	2-18178-01	. . Motor Pulley (45 RPM)(60HZ).....	1
	2-18178-02	. . Motor Pulley (45 RPM)(50HZ).....	1
13	2-18125-01	. Mech Support.....	2
14	2-18124-01	. Cap Plate.....	1
15	2-10364-01	. Thrust Bearing.....	1
16	2-10866-01	. Spacer Bearing.....	1
17	2-18186-01	. Adjusting Bracket Assembly.....	1
18	2-18184-01	. Adjusting Knob.....	1



# MECHANISM ASSEMBLY SHEET 3

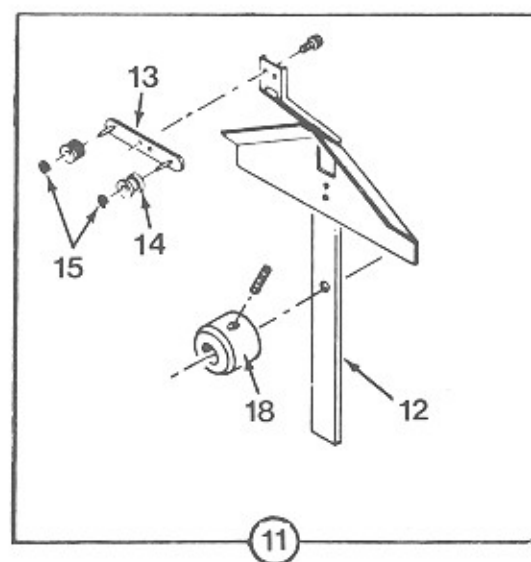
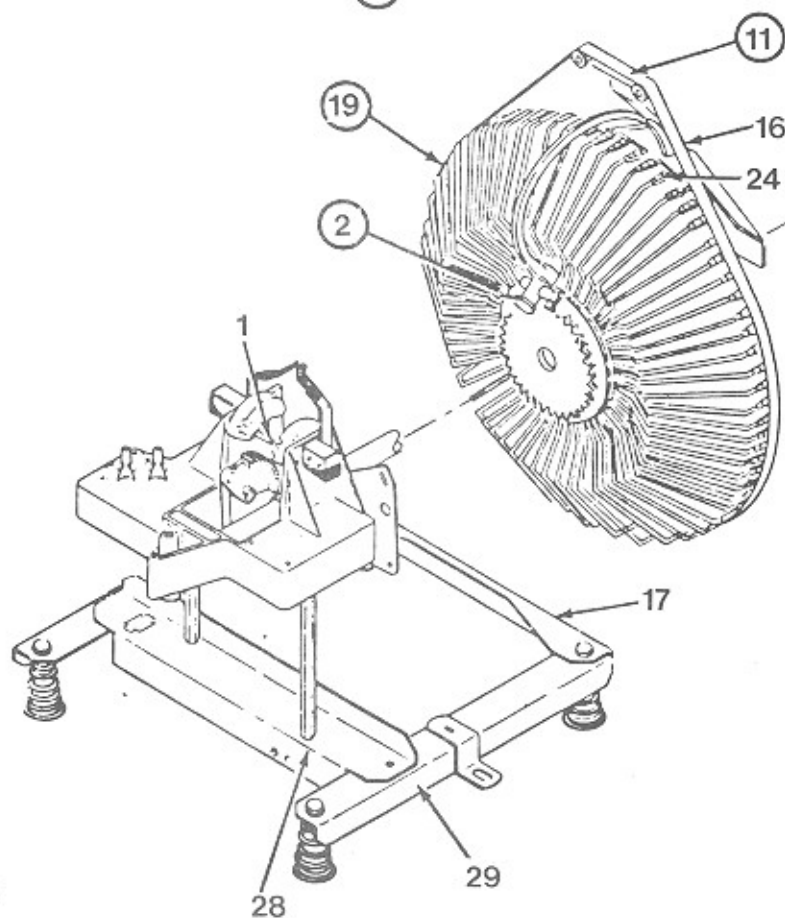
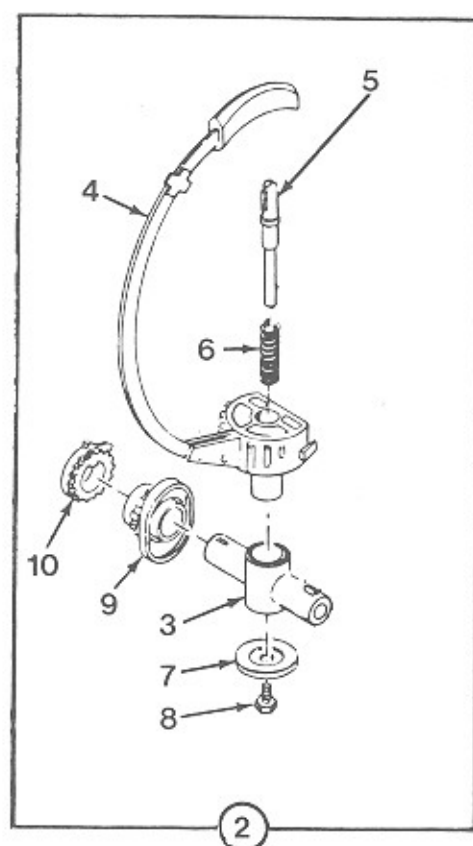
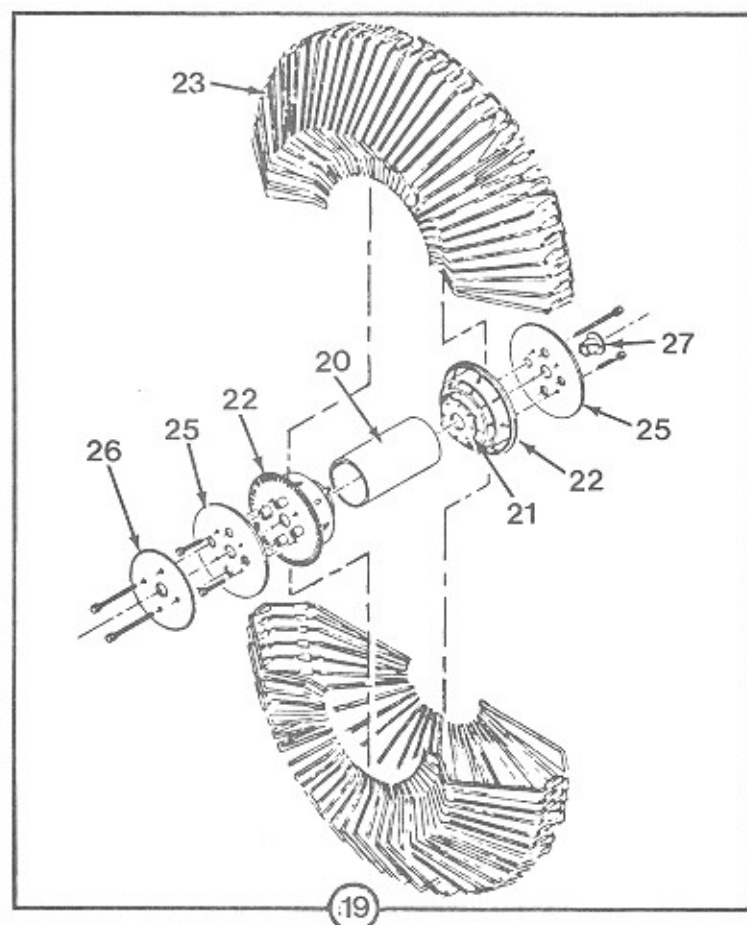

FIG. AND INDEX NO.	ROWE PART NO.	DESCRIPTION	QTY. PER ASSY
-11	6-08700-01	Mechanism Assembly (Continued)	
1	2-10792-02	. Trunnion Pin.....	2
2	4-07207-01	. Gripper & Trunnion Assembly.....	1
3	3-07910-01	. Trunnion.....	1
4	3-05197-02	. Gripper Bow & Hub Assembly.....	1
5	2-10808-03	. Inner Shoe Assembly.....	1
6	2-10811-01	. Record Release Spring.....	1
7	2-18115-01	. Cam Follower.....	1
8	2-18117-01	. Lock Screw.....	1
9	4-07204-01	. Cam Gear.....	1
10	4-07206-01	. Trunnion Gear.....	1
11	4-07212-01	. Guide & Belt Support Assembly.....	1
12	4-07213-01	. Gripper Bow Guide Assembly.....	1
13	2-10894-01	. Roller Bracket Assembly.....	1
14	2-03843-01	. Belt Roller.....	2
15	7-01430-03	. Retaining Ring.....	2
16	2-18138-01	. Belt.....	1
17	3-07925-01	. Support Frame Rear Angle.....	1
18	2-18126-01	. Collar.....	1
19	6-08703-01	. Magazine Assembly.....	1
20	4-07200-01	. Hub Spacer.....	1
21	3-07902-01	. Hub Anchor Plate.....	2
22	6-08702-01	. Magazine Hub.....	2
23	4-07201-01	. Record Magazine Separator.....	100
24	4-07202-01	. Belt Guide.....	100
25	3-07903-01	. Cover Plate.....	2
26	3-07904-01	. Magazine Gear.....	1
27	7-01460-01	. Bearing.....	2
28	2-11013-01	. Lock Nut.....	2
29	3-07914-01	. Mechanism Support & Spring Assembly.....	1
	3-07915-01	. . Mech Support Assembly.....	1
	2-06272-01	. . Spring Support (Upper).....	4
	2-06138-03	. . Mech Mounting Spring.....	4
30	4-07232-01	. Support Magazine.....	1



# MECHANISM ASSEMBLY SHEET 4

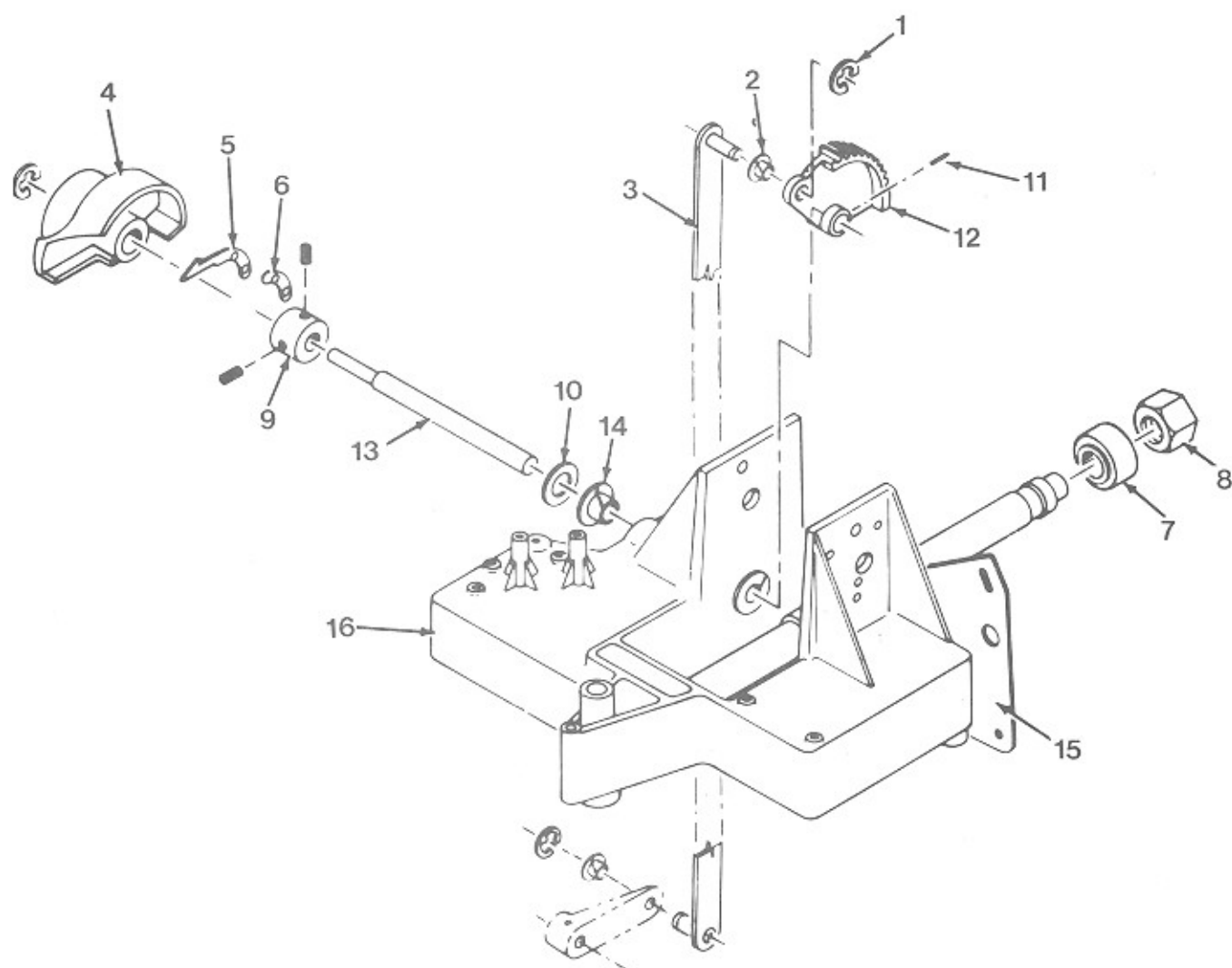

FIG. AND INDEX NO.	ROWE PART NO.	DESCRIPTION	QTY. PER ASSY
-11	6-08700-01	Mechanism Assembly (Continued)	
1	7-01430-04	. Retaining Ring.....	3
2	7-01460-04	. Bearing.....	2
3	2-18102-01	. Transfer Link Assembly.....	1
4	2-18134-01	. Tone Arm Cam Assembly.....	1
	2-18187-01	. . Cam & Insert Assembly.....	1
5	2-18148-01	. Cam Spring.....	1
6	2-18149-01	. Cam Spring Plate.....	1
7	2-51569-06	. Shoulder Washer.....	1
8	7-01301-09	. 9/16 x 18 Jam Nut.....	1
9	2-18133-02	. Cam Collar.....	1
10	7-01225-33	. Bowed Washer.....	1
11	7-01130-19	. Roll Pin.....	1
12	4-07205-01	. Sector Gear.....	1
13	2-18132-01	. Cam Drive Shaft.....	1
14	7-01460-05	. Bearing.....	2
15	4-07218-01	. Intermediate Mounting Plate.....	1
16	4-07211-01	. Base Assembly.....	1
	6-08707-01	. . Mechanims Base.....	1
	3-07913-01	. . Magazine Support Shaft.....	1
	2-10377-01	. . Bearing.....	2

FIGURE  
12

# TONE ARM & PIVOT ASSEMBLY

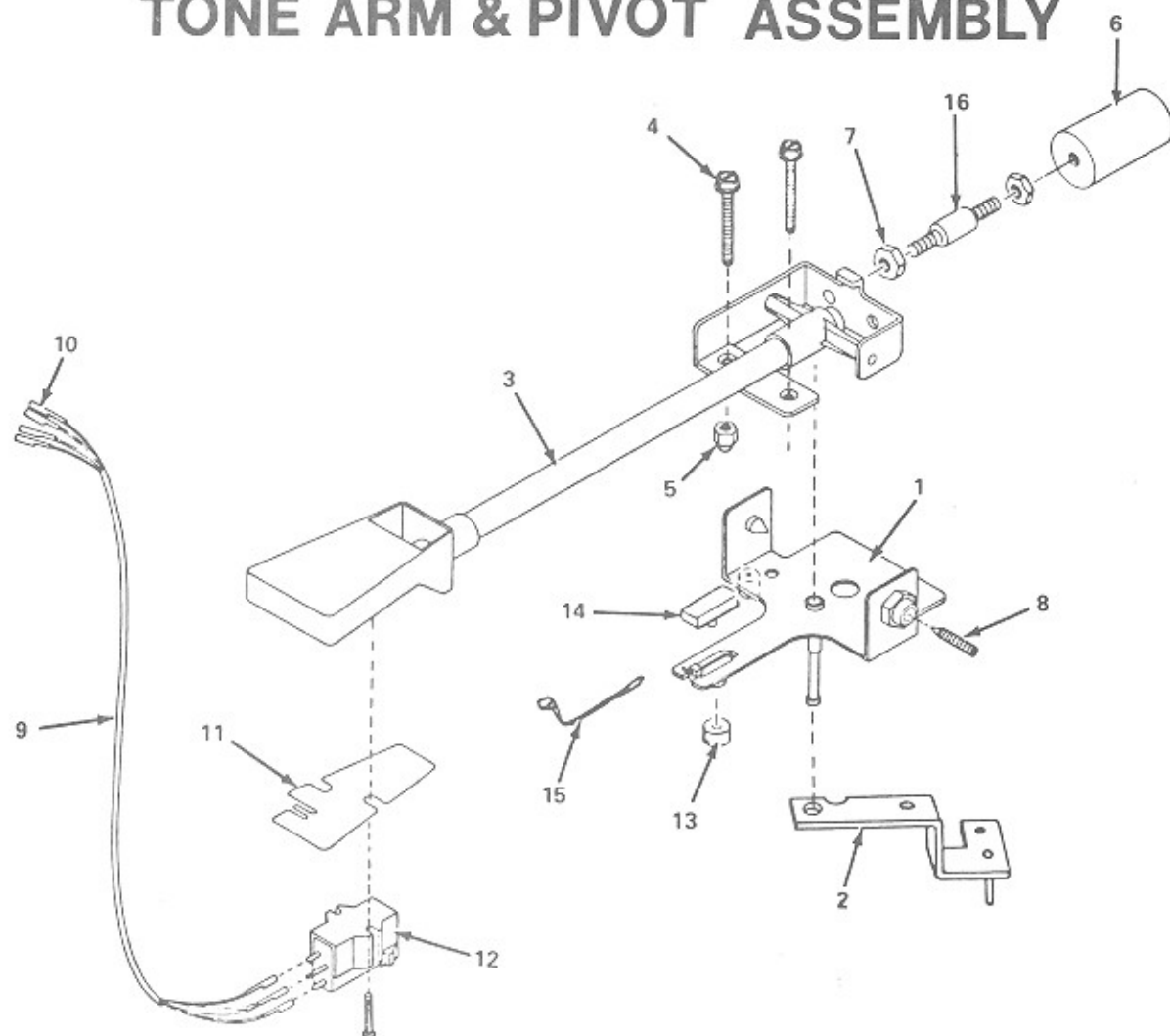

FIG. AND INDEX NO.	ROWE PART NO.	DESCRIPTION	QTY. PER ASSY
-12	4-07217-02	Tone Arm & Pivot Assembly (Figure 1, Sheet 1, Item 5)	
1	2-18141-01	. Bracket & Shaft Assembly.....	1
2	2-18142-01	. Guide Plate Assembly.....	1
3	3-07928-01	. Tone Arm & Lever Assembly.....	1
4	2-65025-01	. Contact Screw.....	2
5	2-18140-01	. Self Locking Cap Nut.....	1
6	2-18143-02	. Counter Weight.....	1
7	7-01355-02	. Locknut.....	1
8	2-10712-01	. Pivot Screw.....	1
9	2-18144-01	. Tone Arm Cable Assembly.....	1
10	7-00927-10	. . Pin Receptacle.....	8
11	3-08915-01	. Tone Arm Shielding Clip.....	1
12	2-13011-01	. Stereo Phono Cartridge.....	1
	2-18340-01	. . Stylus Assembly.....	1
13	2-18147-01	. Magnet - Reed.....	1
14	2-18146-01	. Magnet Clip.....	1
15	7-08001-09	. Cable Tie.....	1
16	2-18177-01	. Vibration Isolator.....	1

# SPRAG ASSEMBLY

FIGURE  
13

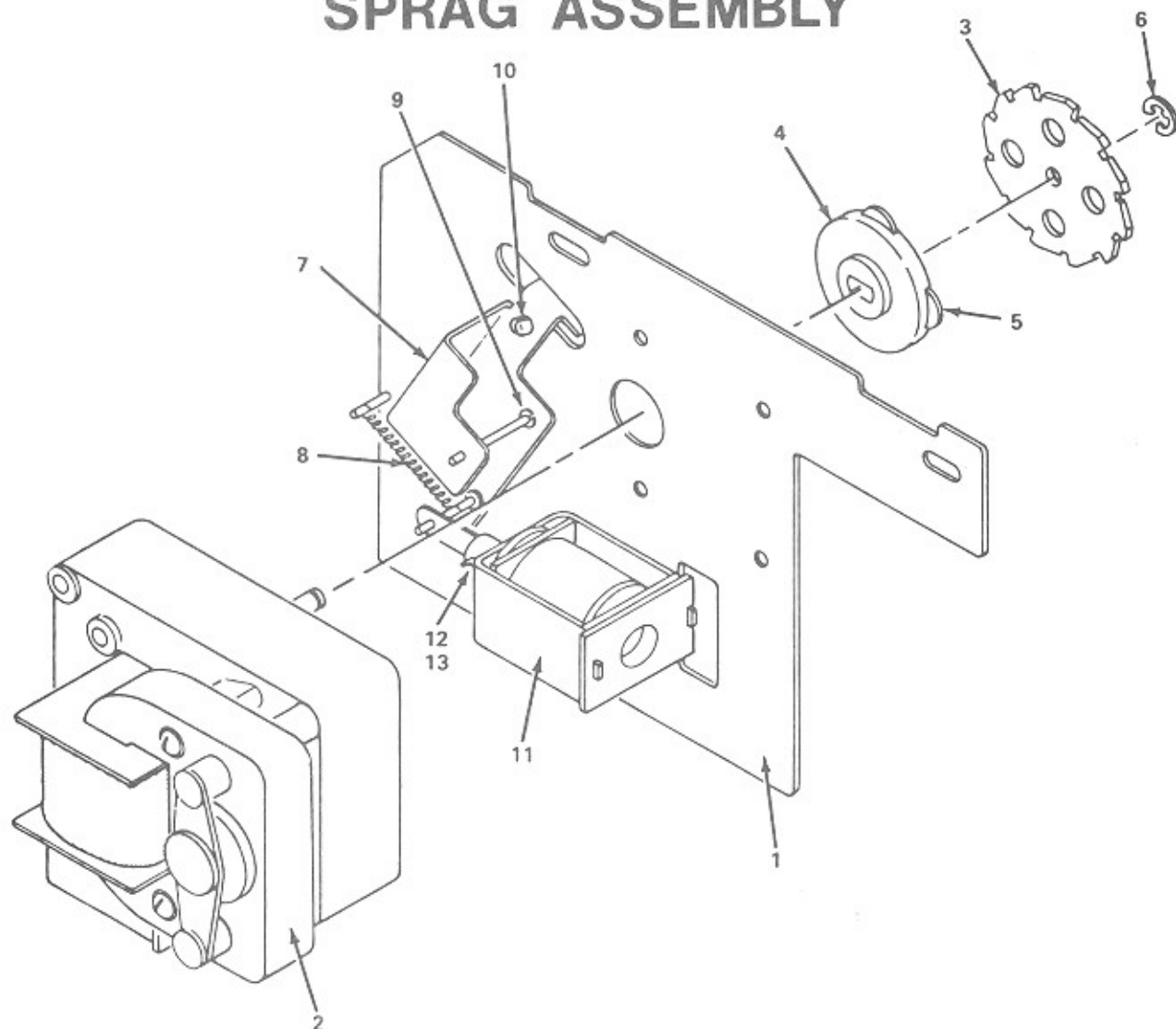

FIG. AND INDEX NO.	ROWE PART NO.	DESCRIPTION	QTY. PER ASSY
-13	4-07219-01	Sprag Assembly (Figure 1, Sheet 2, Item 5)	
1	3-07939-01	. Sprag Plate Assembly.....	1
2	4-07227-01	. Magazine Motor.....	1
3	4-07223-01	. Sprag Wheel.....	1
4	3-07933-01	. Sprag Wheel Hub.....	1
5	2-18161-02	. Stem Bushing.....	4
6	7-01430-03	. Retaining Ring.....	1
7	2-18160-01	. Sprag Lever Assembly.....	1
8	2-12562-01	. Tension Spring.....	1
9	7-01430-05	. Retaining Ring.....	1
10	2-51559-01	. Split Stem Bumper.....	2
11	2-11505-10	. Solenoid Assembly.....	1
12	2-10857-01	. Plunger Assembly. ....	1
13	2-10849-02	. Plunger Stop.....	1

FIGURE  
14

# CAM SWITCH & MOTOR ASSEMBLY

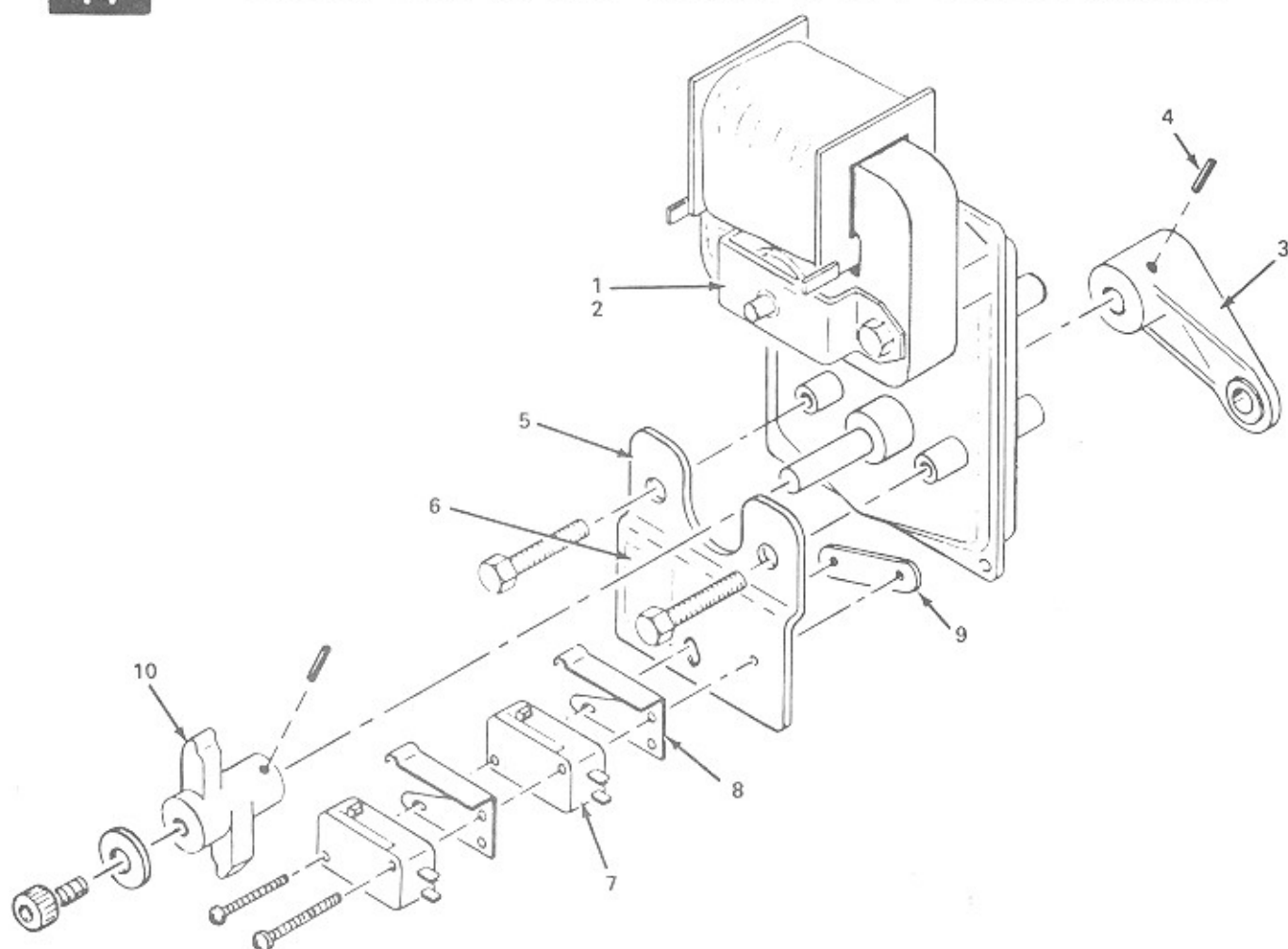

FIG. AND INDEX NO.	ROWE PART NO.	DESCRIPTION	QTY. PER ASSY
-14	4-07208-01	Cam Switch & Motor Assembly (Figure 1, Sheet 1, Item 15)	
1	3-07908-01	. Motor & Crank Assembly.....	1
2	4-07209-01	. Cam Motor.....	1
3	2-18104-01	. Trunnion Crank.....	1
4	7-01131-16	. Roll Pin.....	2
5	3-07909-01	. Switch Plate.....	1
6	2-18169-01	. Cam Switch Label.....	1
7	2-10731-01	. Switch.....	2
8	2-10829-01	. Switch Actuator.....	2
9	2-10830-01	. Twin Nut.....	1
10	3-07934-01	. Switch Cam.....	1

# OBA-2 KIT R-90

FIGURE  
15

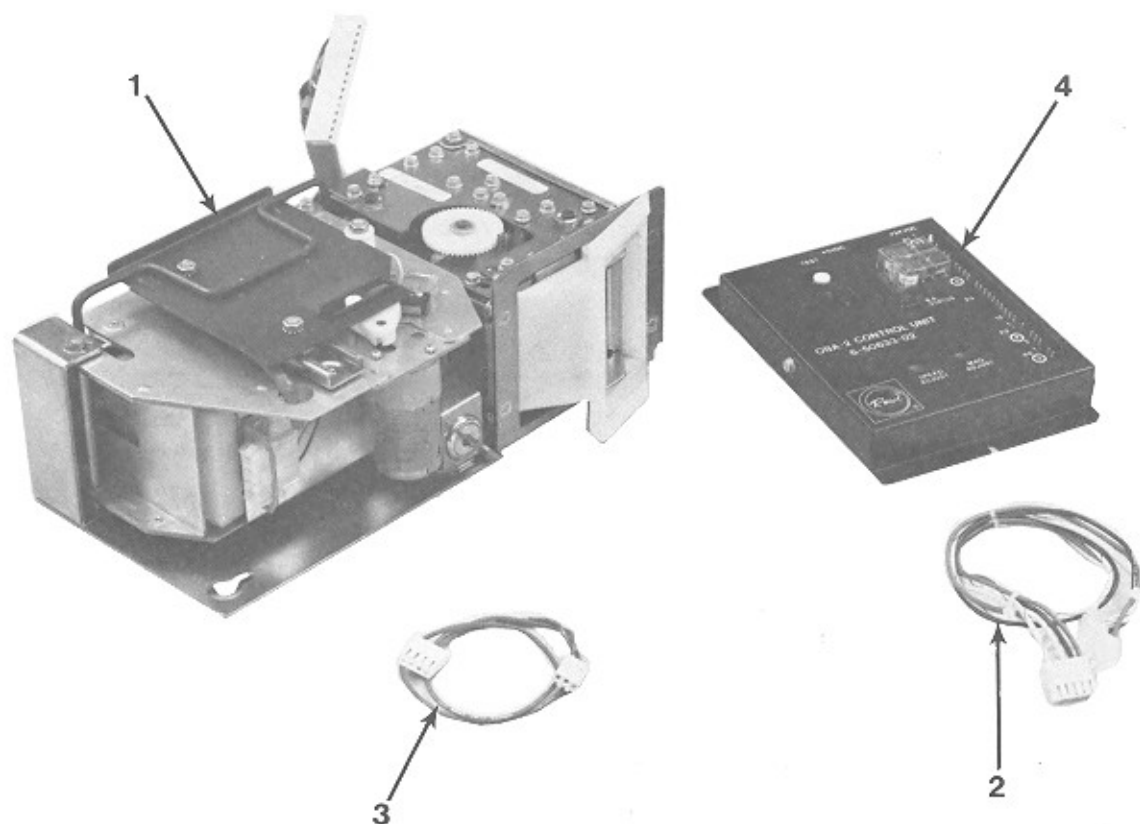

FIG. AND INDEX NO.	ROWE PART NO.	DESCRIPTION	QTY. PER ASSY
-15	6-50570-22	OBA-2 Kit R-90	
1	6-09915-02	. Transport & Stacker Assembly (OBA-2).....	1
2	3-09066-01	. Bill Stacker Harness Assembly.....	1
3	3-09067-01	. Credit Harness Assembly.....	1
4	6-50633-02	. Control Unit OBA-2.....	1

**FIGURE  
16**

# **TRANSPORT ASSEMBLY OBA**

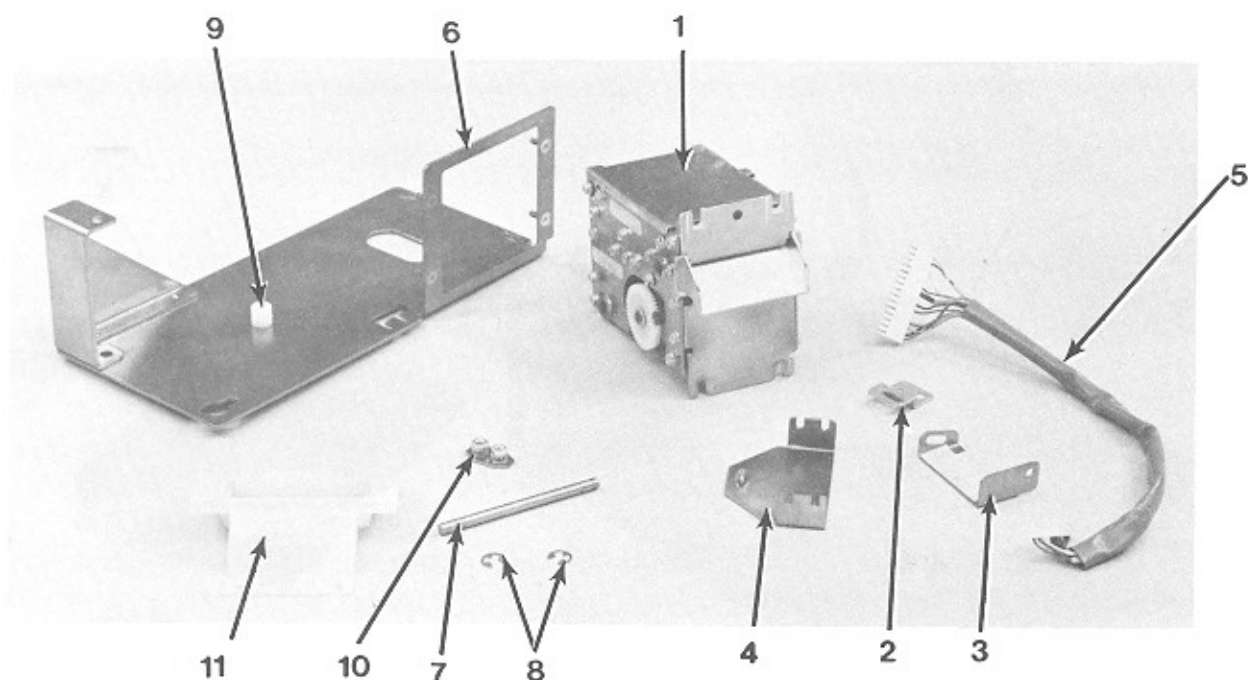

FIG. AND INDEX NO.	ROWE PART NO.	DESCRIPTION	QTY. PER ASSY
-16	6-50565-12	Transport Assembly OBA (R-90)	
1	6-50565-11	. Transport Assembly OBA-2 (1 & 5) BC-1).....	1
2	2-18931-01	. Bill Transport Brace Bracket.....	1
3	3-09061-01	. Harness Support Bracket.....	1
4	3-09062-01	. Plate & Stud Assembly.....	1
5	4-50702-01	. Interconnect Harness Assembly.....	1
6	4-08039-01	. Bracket & Support Assembly.....	1
7	2-15347-08	. Pivot Pin.....	1
8	7-01430-04	. External Retaining Ring.....	2
9	2-15358-05	. Plastic Nut (Self-Retaining).....	1
10	2-18930-01	. Lock Plate Assembly.....	1
11	4-08023-01	. OBA Phono Shroud.....	1



# STACKER ASSEMBLY OBA

FIGURE  
17

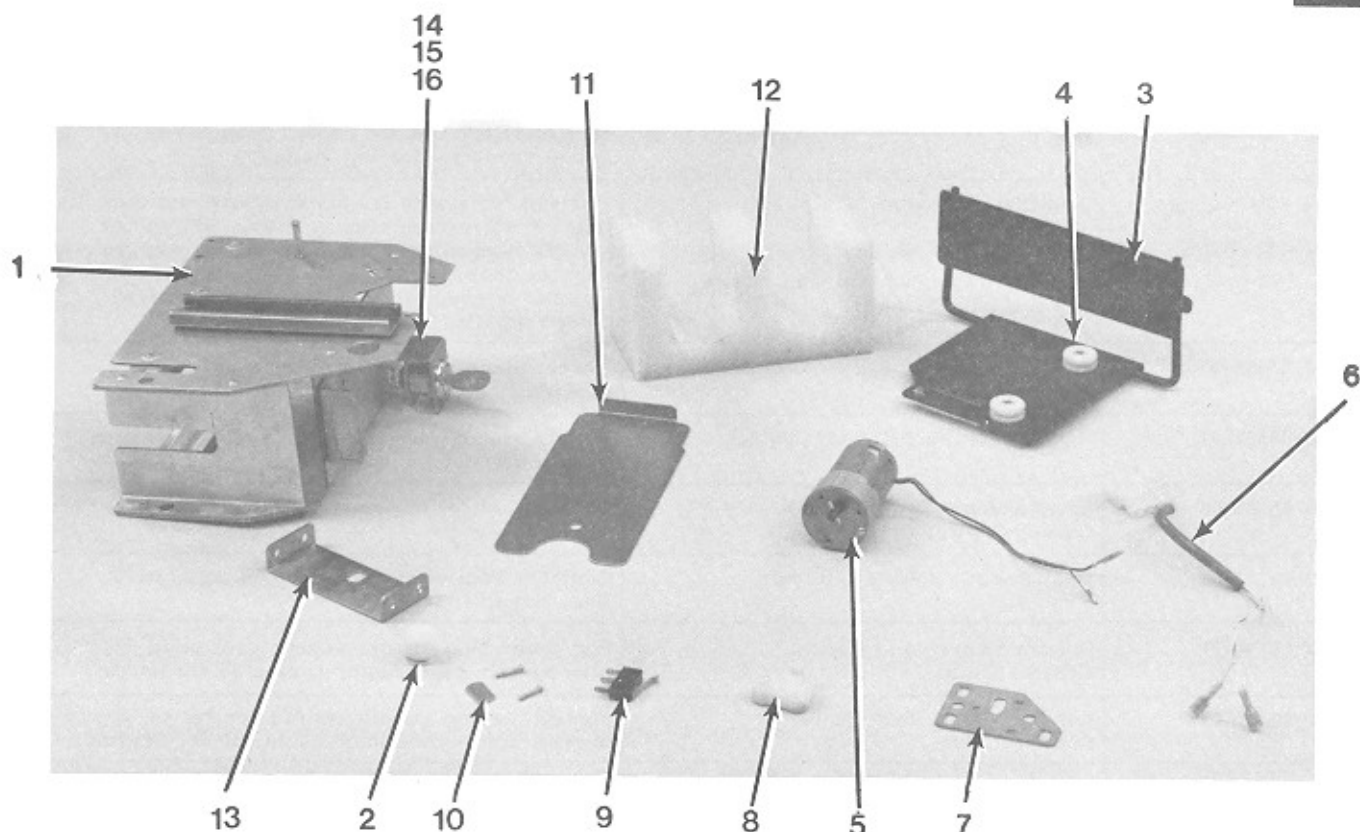

FIG. AND INDEX NO.	ROWE PART NO.	DESCRIPTION	QTY. PER ASSY
-17	6-07979-03	Stacker Assembly OBA (300 Bill)	
1	4-07915-02	. Bill Box Assembly (Rivet).....	1
2	2-16292-01	. Guide Spacer.....	1
3	4-07918-02	. Push Plate Assembly (Weld).....	1
4	2-16300-01	. Slide Spacer.....	2
5	3-08781-01	. Motor & Pin Assembly.....	1
6	2-16290-01	. Motor Harness Assembly.....	1
7	3-08777-01	. Motor Mounting Plate.....	1
8	3-08774-02	. Bill Stacker Cam.....	1
9	2-16309-01	. Miniature Switch.....	1
10	2-16307-01	. Twin Nut.....	1
11	3-50392-04	. Pressure Plate.....	1
12	2-50961-06	. Foam Block.....	1
13	3-09063-01	. Bill Stacker Stop Plate.....	1
14	7-01620-08	. Lock Cylinder (Indiv. Keying).....	1
15	7-01660-12	. Straight Lockbolt.....	1
16	2-18932-01	. Lock Bracket.....	1

TABLE I-1 ACCESSORY EQUIPMENT

PART NO.	DESCRIPTION	FUNCTION
6-50570-23	One & Five Dollar Bill Acceptor Kit (Includes Bill Stacker)	Accepts valid one & five dollar bills
2-66946-04	Phono Paging System	Paging System not affected by A.V.C. All Plug in unit, complete with microphone and 50 feet of microphone cable. Allows use of phono sound system for paging
2-66947-02	Amplifier Accessory Kit	Provides access to auxiliary inputs and outputs of the preamplifier. Inputs will accept signals from most background music sources such as tape players and AM or FM radios. Outputs available to drive slave amplifiers before or after volume control.
2-67003-01	125/130 Watt Amplifier Harness Kit	Three Adapter Cables to interchange Combo-Line plugs with Universal plugs.
3-06322-01	Remote Volume & Cancel Control	Remote stereo volume control and cancel button. Does not include cable.
6-08980-04	Remote Volume Power Switch & Cancel Control	Volume Control incorporates on-off switch. 115 V only.
3-06322-09	Dual Remote Volume Control	Controls Volume of each channel separately. Does not include cable.
2-08199-07	Remote Volume and Cancel Control Cable	For connecting remote volume control to phonograph 3-conductor cable, 50 ft. length.
2-08199-08	Remote Volume and Cancel Control Cable	For connecting remote volume control to phonograph 4-conductor cable, 50 ft. length.
6-65047-08	Service Kit	Includes Central Computer, Mech. Control, Power Supply Board and Fuses.
6-07447-01	Extension Speaker (Model EX 350)	32 watt, two channel system includes 3½-inch tweeter and 10-inch bass speaker.
6-09025-01	WRF Wallette Wallbox	Remote control unit for solid state phonograph. R-90 and video takes nickels, dimes, quarters and half dollars.
2-66989-06	Wallbox Adaptor Harness Kit (WRF)	For making internal connections in phonograph to allow installation of WRF Wallbox.
4-06891-01	Auxiliary Power Supply	Permits operation with WRA, WRB, WRC, WRD & WRE, WRF Wallboxes.
0-05080-00 Belden No. 8447 Columbia No. 4082	7 Conductor Cable	For connecting WRF to phonograph. (Not supplied by Rowe)
2-66995-03	Security Bar Kit	Heavy steel bar locks in place over cash box door.
2-67025-01	Conversion Kit	Converts WRE to WRF Wallette
2-67028-02	Wallbox Interface Kit	Permits operation of WRA, WRC, WRD, WRE, and Seeburg wallboxes with R-90 phono.
2-67040-01	Paint - Touch up (Spice Metallic Dark)	
2-67041-01	Paint - Touch up (Rose Beige Metallic Light)	
2-67042-01	Paint - Touch up (Day Star Blue Dark)	
2-67043-01	Paint - Touch up (Ensign Blue Dark)	