

PRO-2006 PROGRAMMABLE
SCANNER (200-0145)
FAXBACK DOC # 21345

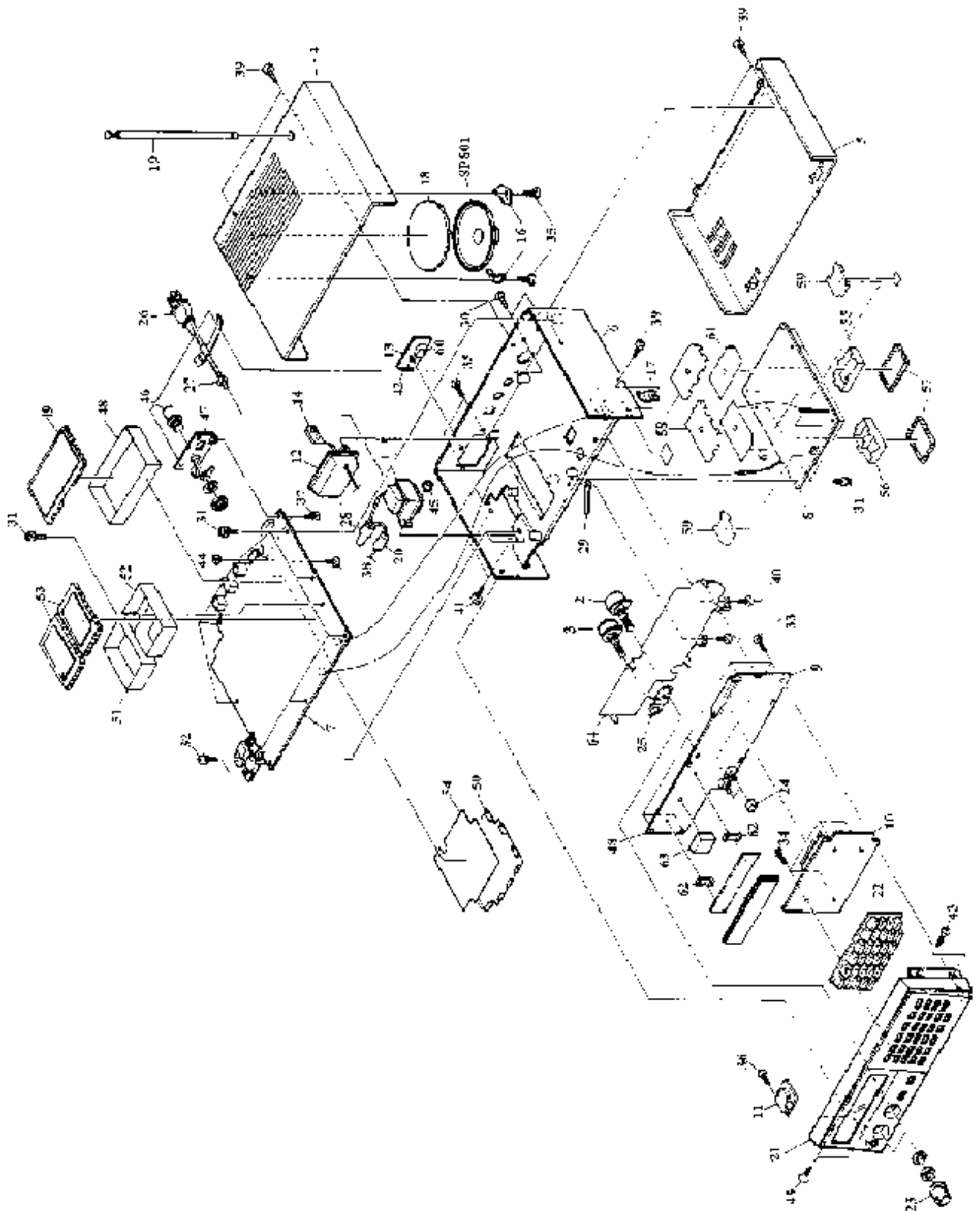

SCHEMATIC DIAGRAM (LINEAR SECTION)

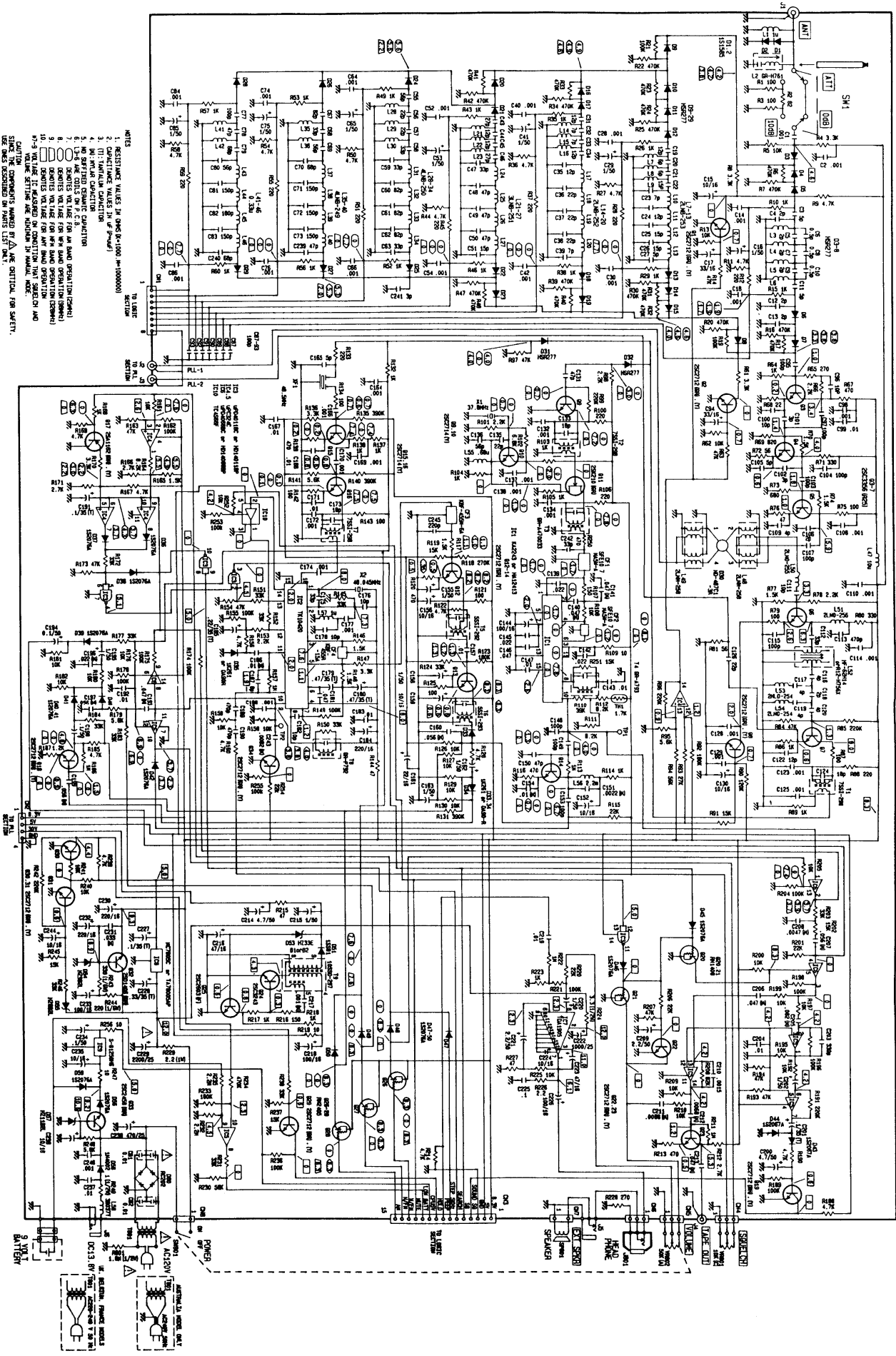

- NOTES
1. RESISTANCE VALUES IN OHMS UNLESS OTHERWISE SPECIFIED
 2. CAPACITANCE VALUES IN MICROFARADS UNLESS OTHERWISE SPECIFIED
 3. T: THERMISTOR
 4. W: VARIABLE CAPACITOR
 5. S: SPHERICAL CAPACITOR
 6. R: RECTIFIER
 7. C: CONDENSER
 8. V: VALVE
 9. P: PHONO PICKUP
 10. B: BATTERY
 11. T: THERMISTOR
 12. W: VARIABLE CAPACITOR
 13. S: SPHERICAL CAPACITOR
 14. R: RECTIFIER
 15. V: VALVE
 16. P: PHONO PICKUP
 17. B: BATTERY

SINCE THE COMPONENTS MARKED WITH A TRIANGLE ARE CRITICAL TO SAFETY, USE PARTS DESIGNATED BY PARTS LIST ONLY.

SCHEMATIC DIAGRAM (CPU SECTION)

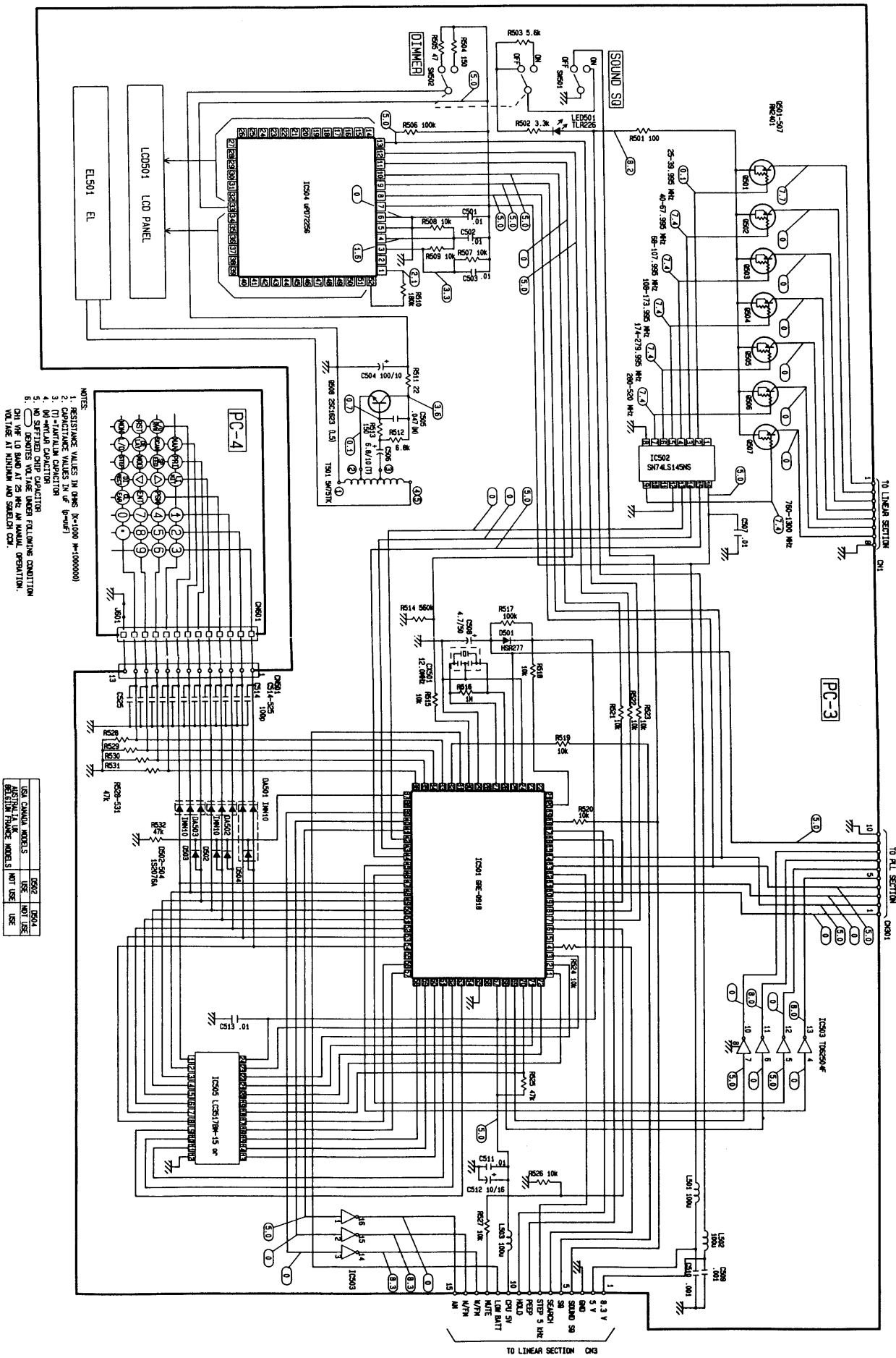

- NOTES
1. RESISTANCE VALUES IN OHMS (R=1000 M=1000000)
 2. CAPACITANCE VALUES IN μF (μ=1000 n=1000000)
 3. Ω = OHMS
 4. Ω = OHMS
 5. Ω = OHMS
 6. Ω = OHMS
 7. Ω = OHMS
 8. Ω = OHMS
 9. Ω = OHMS
 10. Ω = OHMS
 11. Ω = OHMS
 12. Ω = OHMS
 13. Ω = OHMS
 14. Ω = OHMS
 15. Ω = OHMS
 16. Ω = OHMS
 17. Ω = OHMS
 18. Ω = OHMS
 19. Ω = OHMS
 20. Ω = OHMS
 21. Ω = OHMS
 22. Ω = OHMS
 23. Ω = OHMS
 24. Ω = OHMS
 25. Ω = OHMS
 26. Ω = OHMS
 27. Ω = OHMS
 28. Ω = OHMS
 29. Ω = OHMS
 30. Ω = OHMS
 31. Ω = OHMS
 32. Ω = OHMS
 33. Ω = OHMS
 34. Ω = OHMS
 35. Ω = OHMS
 36. Ω = OHMS
 37. Ω = OHMS
 38. Ω = OHMS
 39. Ω = OHMS
 40. Ω = OHMS
 41. Ω = OHMS
 42. Ω = OHMS
 43. Ω = OHMS
 44. Ω = OHMS
 45. Ω = OHMS
 46. Ω = OHMS
 47. Ω = OHMS
 48. Ω = OHMS
 49. Ω = OHMS
 50. Ω = OHMS
 51. Ω = OHMS
 52. Ω = OHMS
 53. Ω = OHMS
 54. Ω = OHMS
 55. Ω = OHMS
 56. Ω = OHMS
 57. Ω = OHMS
 58. Ω = OHMS
 59. Ω = OHMS
 60. Ω = OHMS
 61. Ω = OHMS
 62. Ω = OHMS
 63. Ω = OHMS
 64. Ω = OHMS
 65. Ω = OHMS
 66. Ω = OHMS
 67. Ω = OHMS
 68. Ω = OHMS
 69. Ω = OHMS
 70. Ω = OHMS
 71. Ω = OHMS
 72. Ω = OHMS
 73. Ω = OHMS
 74. Ω = OHMS
 75. Ω = OHMS
 76. Ω = OHMS
 77. Ω = OHMS
 78. Ω = OHMS
 79. Ω = OHMS
 80. Ω = OHMS
 81. Ω = OHMS
 82. Ω = OHMS
 83. Ω = OHMS
 84. Ω = OHMS
 85. Ω = OHMS
 86. Ω = OHMS
 87. Ω = OHMS
 88. Ω = OHMS
 89. Ω = OHMS
 90. Ω = OHMS
 91. Ω = OHMS
 92. Ω = OHMS
 93. Ω = OHMS
 94. Ω = OHMS
 95. Ω = OHMS
 96. Ω = OHMS
 97. Ω = OHMS
 98. Ω = OHMS
 99. Ω = OHMS
 100. Ω = OHMS

USE CHANNEL MODELS	USE	NOT USE
1501-901	USE	NOT USE
1501-902	USE	NOT USE
1501-903	USE	NOT USE
1501-904	USE	NOT USE
1501-905	USE	NOT USE
1501-906	USE	NOT USE
1501-907	USE	NOT USE
1501-908	USE	NOT USE
1501-909	USE	NOT USE
1501-910	USE	NOT USE
1501-911	USE	NOT USE
1501-912	USE	NOT USE
1501-913	USE	NOT USE
1501-914	USE	NOT USE
1501-915	USE	NOT USE
1501-916	USE	NOT USE
1501-917	USE	NOT USE
1501-918	USE	NOT USE
1501-919	USE	NOT USE
1501-920	USE	NOT USE
1501-921	USE	NOT USE
1501-922	USE	NOT USE
1501-923	USE	NOT USE
1501-924	USE	NOT USE
1501-925	USE	NOT USE
1501-926	USE	NOT USE
1501-927	USE	NOT USE
1501-928	USE	NOT USE
1501-929	USE	NOT USE
1501-930	USE	NOT USE
1501-931	USE	NOT USE
1501-932	USE	NOT USE
1501-933	USE	NOT USE
1501-934	USE	NOT USE
1501-935	USE	NOT USE
1501-936	USE	NOT USE
1501-937	USE	NOT USE
1501-938	USE	NOT USE
1501-939	USE	NOT USE
1501-940	USE	NOT USE
1501-941	USE	NOT USE
1501-942	USE	NOT USE
1501-943	USE	NOT USE
1501-944	USE	NOT USE
1501-945	USE	NOT USE
1501-946	USE	NOT USE
1501-947	USE	NOT USE
1501-948	USE	NOT USE
1501-949	USE	NOT USE
1501-950	USE	NOT USE
1501-951	USE	NOT USE
1501-952	USE	NOT USE
1501-953	USE	NOT USE
1501-954	USE	NOT USE
1501-955	USE	NOT USE
1501-956	USE	NOT USE
1501-957	USE	NOT USE
1501-958	USE	NOT USE
1501-959	USE	NOT USE
1501-960	USE	NOT USE
1501-961	USE	NOT USE
1501-962	USE	NOT USE
1501-963	USE	NOT USE
1501-964	USE	NOT USE
1501-965	USE	NOT USE
1501-966	USE	NOT USE
1501-967	USE	NOT USE
1501-968	USE	NOT USE
1501-969	USE	NOT USE
1501-970	USE	NOT USE
1501-971	USE	NOT USE
1501-972	USE	NOT USE
1501-973	USE	NOT USE
1501-974	USE	NOT USE
1501-975	USE	NOT USE
1501-976	USE	NOT USE
1501-977	USE	NOT USE
1501-978	USE	NOT USE
1501-979	USE	NOT USE
1501-980	USE	NOT USE
1501-981	USE	NOT USE
1501-982	USE	NOT USE
1501-983	USE	NOT USE
1501-984	USE	NOT USE
1501-985	USE	NOT USE
1501-986	USE	NOT USE
1501-987	USE	NOT USE
1501-988	USE	NOT USE
1501-989	USE	NOT USE
1501-990	USE	NOT USE
1501-991	USE	NOT USE
1501-992	USE	NOT USE
1501-993	USE	NOT USE
1501-994	USE	NOT USE
1501-995	USE	NOT USE
1501-996	USE	NOT USE
1501-997	USE	NOT USE
1501-998	USE	NOT USE
1501-999	USE	NOT USE
1501-1000	USE	NOT USE

SCHEMATIC DIAGRAM (PLL SECTION)

