

ELECTROLUX ZANUSSI VENDING S.P.A. RESERVES THE RIGHT OF ABSOLUTE OWNERSHIP OF THIS DESIGN. ANY REPRODUCTION OR DISCLOSURE OF THE DESIGN WITHOUT PREVIOUS AUTHORIZATION IS STRICTLY FORBIDDEN.

DATE

FEED

SIGNATURE

Electrolux

ZANUSSI VENDING

MOUNTING INSTRUCTIONS
FOR COOLING UNIT KIT - SPAZIO

ENGLISH

CODE
599597300

FILLED OUT
SIRBU

TESTED
PERSONENI

SHEET
1/2
DATE
25-11-98

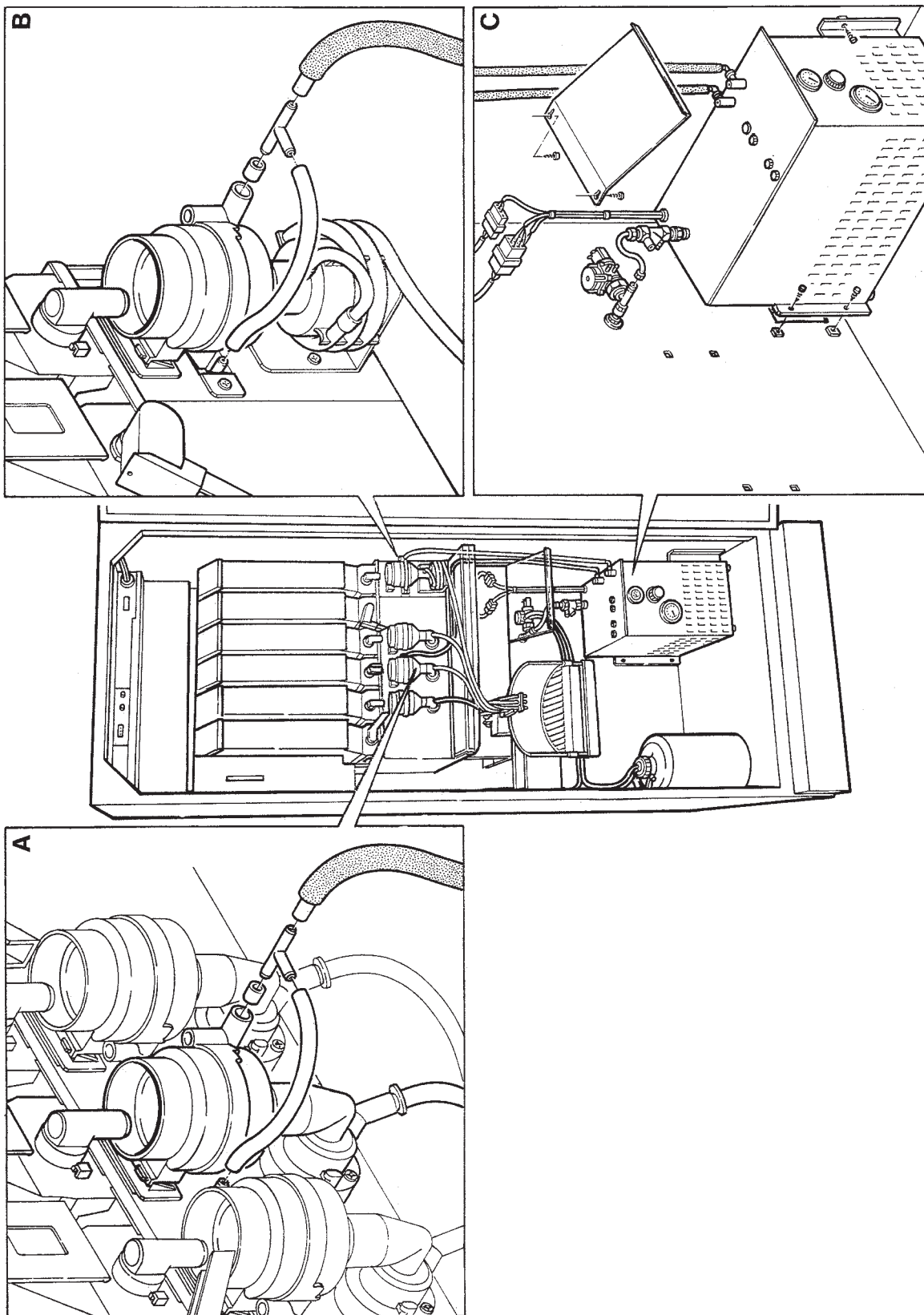

KIT MOUNTING

1. Remove the air grille cover which is located on the back of the vending machine at the lower right rear.
2. Disconnect the vending machine from the electrical supply.
3. Remove the coin box, the water filter, the tubing fixing clips, the drain pan (located under the mixer) and its cover.
4. Locate the unit as shown in figure **C** and attach it with the self-tapping screws.
5. Locate cooling unit cover as shown in figure **C** and fix it by means of the two self-tapping screws kit supplied.

ELECTRICAL CONNECTIONS

1. Connect the two connectors of the cooling unit with those of cables available in the vending machine.
2. Replace the lower mixing cover, keeping all the connectors facing to the inside.
3. Replace the drain pan.

WATER CONNECTIONS

1. Disconnect the vending machine from the water supply.
2. Unscrew the water inlep cap and connect the water inlet tube to the unit's water inlet connection (figure **C**).
3. Connect the leaving cold water tube (located on the right) to the 4th mixer on the right of the vending machine following the design in figure **B**.
4. Connect the second leaving cold water tube (located on the left) to the 2nd mixer on the right of the vending machine following the design in figure **A**.
5. Replace the coin box, the water filter and the tubing fixing clips and then reconnect the vending machine to the water supply.
6. To set up the vending machine to operate with this kit, refer to the table showing the dose amounts.
7. Run the unit several times, until a normal product's dose begins to flow through the nozzles.

DATE

FEED

SIGNATURE